

ATA-2

Automatic Transaxle System

General Information

Specification

Transmission		6HP26 (ZF)
Engine		Gasoline 4.6L/ Diesel 3.0
Driving system		2WD (4WD option)
Oil pump system		Involute type (Engine driving)
Gear ratio	1st	4.171
	2nd	2.340
	3rd	1.521
	4th	1.143
	5th	0.867
	6th	0.691
	Reverse	3.403
Solenoid	3-way	1ea [MV1]
	Linear	6ea[EDS1,EDS2,EDS3,EDS4,EDS5,EDS6]
ATF		Shell M-1375.4

دیجیتال خودرو
شرکت دیجیتال خودرو سامانه (مسئولیت محدود)

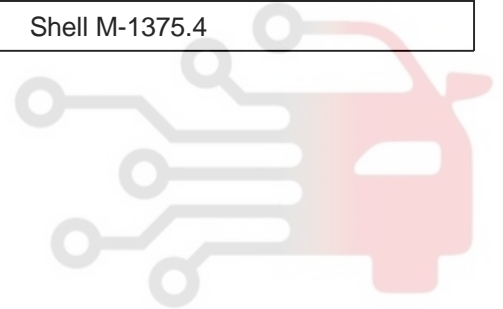

اولین سامانه دیجیتال تعمیرکاران خودرو در ایران



General Information

ATA-3

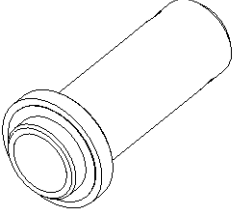
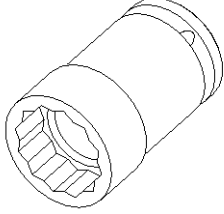
Service Special Tools

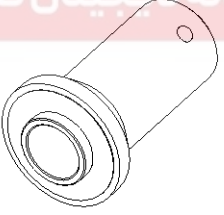
Tools (Number and Name)	Illustration	Use
09452-2J100 Oil seal installer	 <p style="text-align: center;">SHMAT8020D</p>	Installation of oil seal of oil pump.
09452-2J200 Locking nut socket	 <p style="text-align: center;">SHMAT8021D</p>	Removal and installation of locking nut.
09452-2J300 Oil seal installer	 <p style="text-align: center;">SHMAA9002N</p>	Installation of oil seal of manual shaft.
09452-2J400 Oil seal installer	 <p style="text-align: center;">SHMAT8023D</p>	Installation of oil seal of transmission case.

ATA-4

Automatic Transaxle System

Automatic Transaxle System

Brief Description

The 6 forward gears and the reverse gear are generated by a double planetary gear set (Ravigneaux) and a front-mounted simple planetary gear.

The way these planetary gear-sets work together, is patented (Lepelletier).

Also new: The stationary disconnect feature, what means that the gearbox is disconnected from the power train at standstill (clutch A is open).

This causes an additional reduction of fuel consumption.

Former the torque converter ran against the motor (foot on the brake) at standstill.

The 6HP26 uses the new "ASIS" shift strategy developed by ZF (Adaptive Shift Strategy).

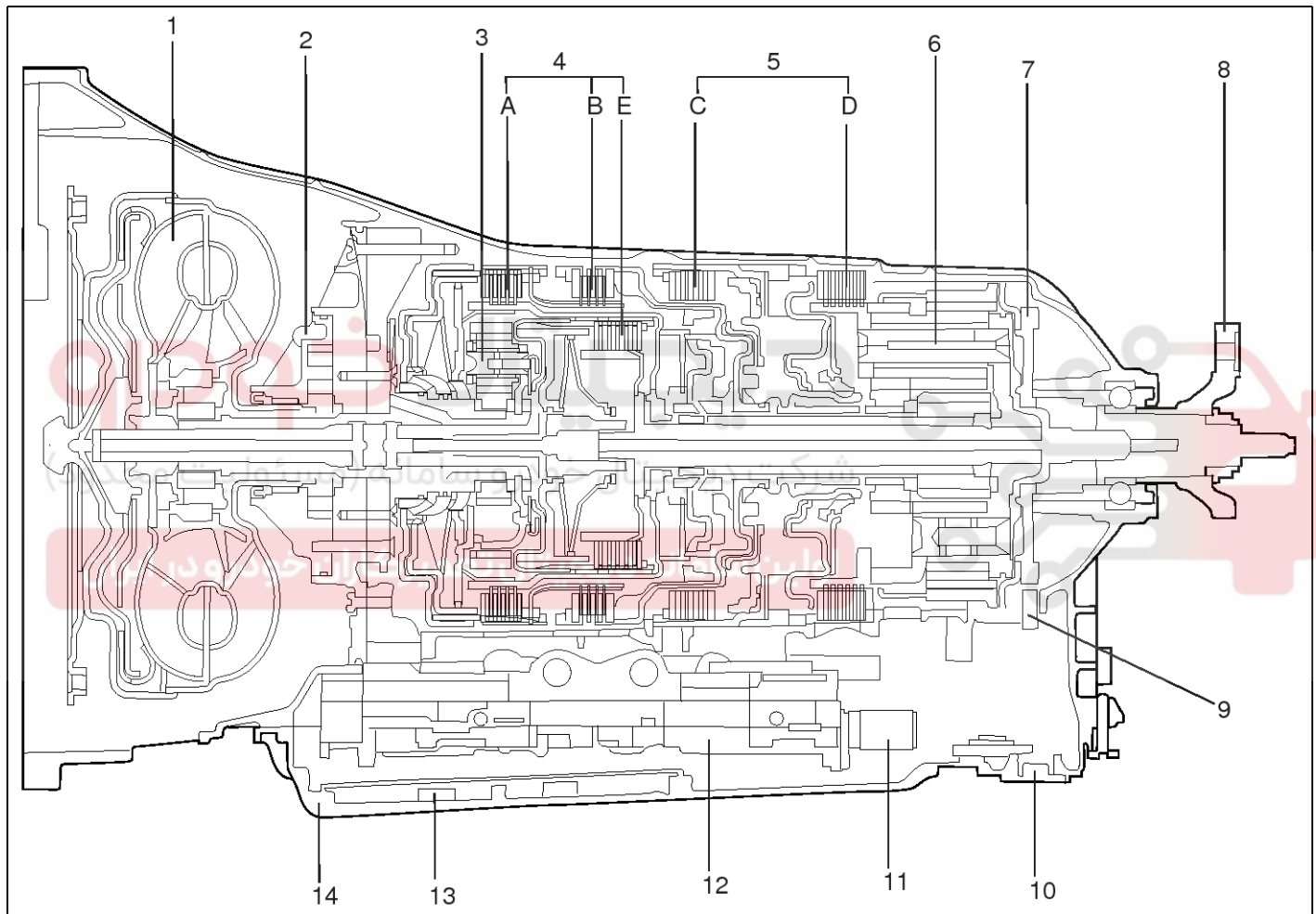

SHMAT8031D

- | | |
|--------------------------------|-----------------------------|
| 1. Torque converter | 8. Output flange |
| 2. Oil pump | 9. Parking lock pawl |
| 3. Front single planetary gear | 10. Drain plug |
| 4. Clutch | 11. Pressure regulator |
| 5. Brake | 13. Mechatronik(V/Body+TCU) |
| 6. Front double planetary gear | 14. Oil strainer |
| 7. Parking lock wheel | 15. Oil pan |

Automatic Transaxle System

ATA-5

Operating Elements

Shift position	Solenoids							Clutch				Brake	
	MV1	P-EDS						A	B	E	LC	C	D
		1	2	3	4	5	6						
P (Parking)			○			○							○
R (Reverse)						○			○				○
N (Neutral)			○			○							○
D 1st		○	○			○	○	○			○		○
D 2nd		○	○	○	○	○	○	○			○	○	
D 3rd		○			○	○	○	○	○		○		
D 4th	○	○	○			○	○	○		○	○		
D 5th	○					○	○		○	○	○		
D 6th	○		○	○		○	○			○	○	○	

*MV1 : EDS4 Switching function (OFF: Clutch-E, ON: Brake-D)

*LC : Lock-up clutch

Mechatronik

Mechatronik consists of the hydraulic valve body assembly and the TCU module.

There are the TCU, two speed sensors, position sensor (inhibitor switch), oil temperature sensor on the E-module.

Position sensor

	P	Z1	R	Z2	N	Z3	D
L1	0	0	0	0	0	1	1
L2	0	0	0	1	1	1	1
L3	1	1	0	0	0	0	1
L4	0	1	1	1	0	0	0

Key to sensor coding:

Logical 0 means transistor block, electric high

Logical 1 means transistor pass, electric low

X means this wire is needed

Z means intermediate position

Task of position sensor

Conversion of linear shift valve or parking lock movement into a parallel coded signal on 4 wires (L1, L2, L3, L4) in accordance with the positions P, R, N, D, 4, 3, 2 and P_on and P_off (parking lock engaged/disengaged)

The two speed sensors for turbine and output speeds and the oil temperature sensor and position switch are integrated into the TCU module and are not detachable.

The solenoid valves and pressure regulators are attached by the knife-edge clamping technique.

ATA-6

Automatic Transaxle System

Components(1)

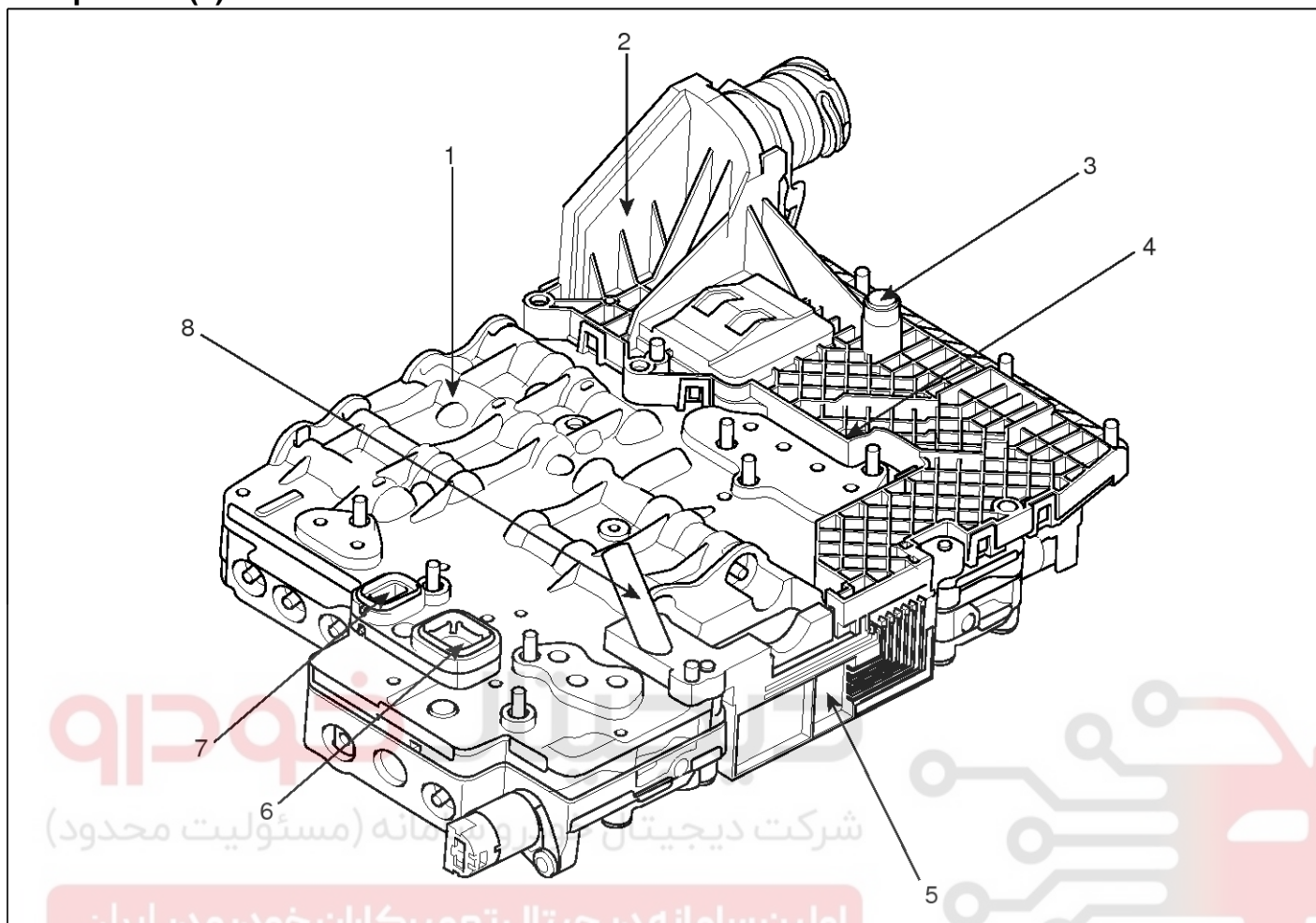

SHMAT8032D

- | | |
|---------------------------|-----------------------|
| 1. Hydraulic Module | 5. Position sensor |
| 2. TCU Module | 6. Discharge port |
| 3. Output speed sensor | 7. Suction port |
| 4. Oil temperature sensor | 8. Input speed sensor |

Automatic Transaxle System

ATA-7

Components(2)

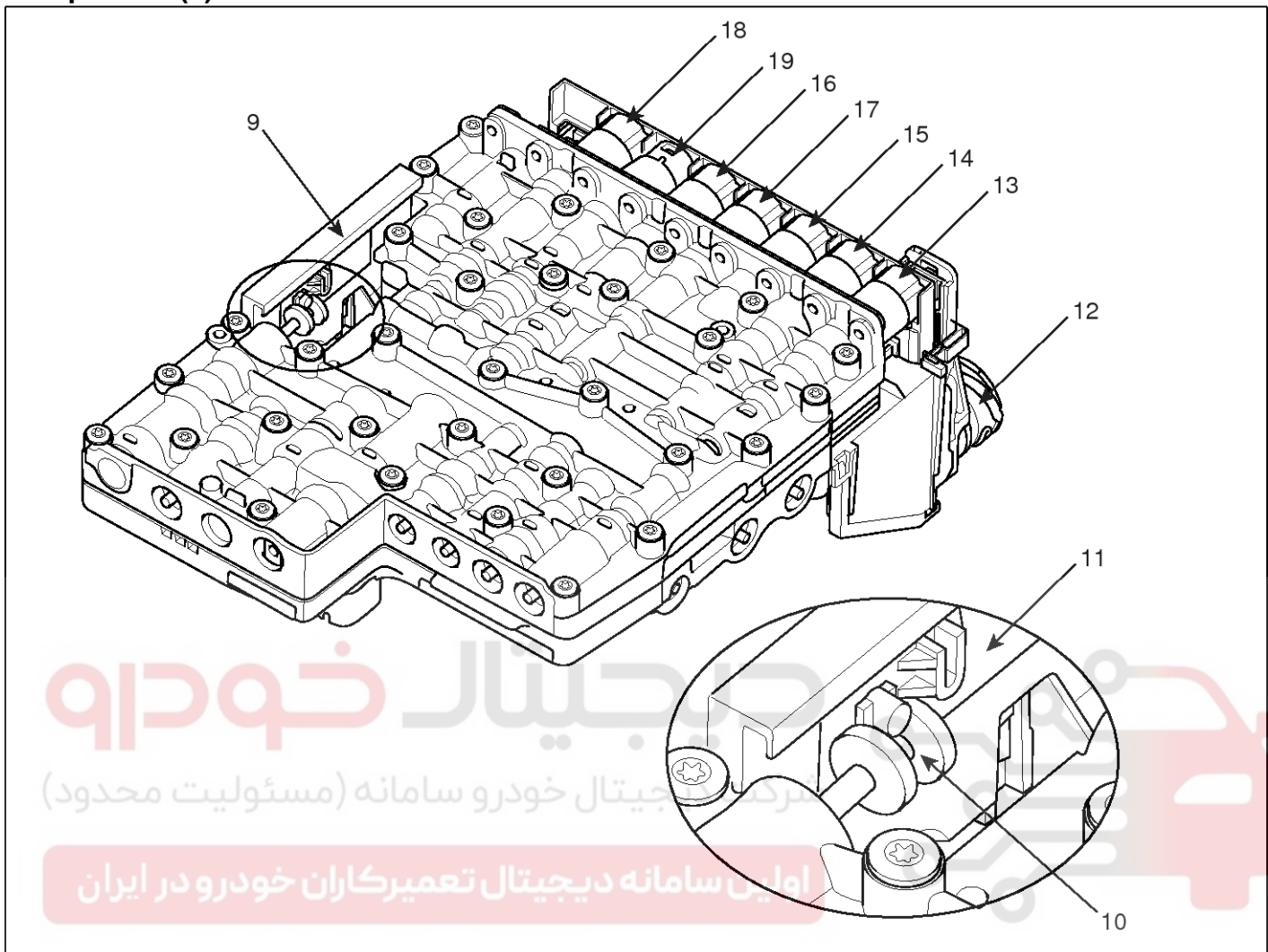

SHMAT8033D

- | | |
|--------------------------|-----------|
| 9. Position switch | 15. EDS 3 |
| 10. Selector valve | 16. EDS 4 |
| 11. Sliding block | 17. EDS 5 |
| 12. TCU Module connector | 18. EDS 6 |
| 13. EDS 1 | 19. MV 1 |
| 14. EDS 2 | |

ATA-8

Automatic Transaxle System

Inspection And Adjustment

Procedure Of ATF Level Inspection

1. Park the vehicle on a level surface and set the parking brake.
2. Shift the shift lever to "P" range.
3. Start the engine.
4. Shift through all ranges (P-R-N-D-3). Stay in each range for more than 3 seconds.
Then return to "P".

NOTICE

Use the sport mode to shift to "3".

5. Wait until ATF temperature has reached at 30~35°C(86~95°F).

CAUTION

Do not raise ATF temperature by "Stall test"

6. Using a TORX wrench (8mm), remove the filler plug (A).

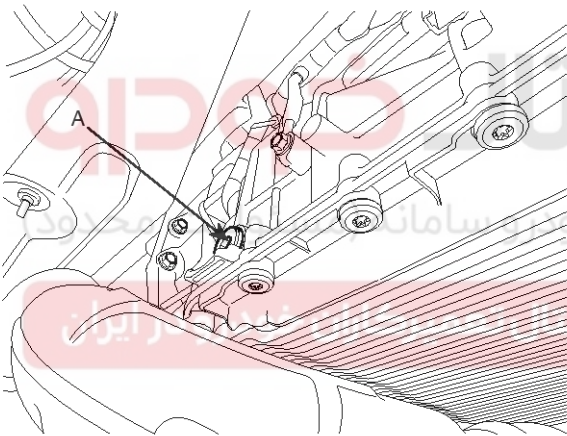

SHMAA9001N

7. Check for ATF flow from the overflow hole. Add ATF as needed until fluid flows from the overflow hole.

Specified ATF : Shell M-1375.4

8. Check that the ATF flows out of the overflow hole at 30~50°C(86~122°F).

CAUTION

Be careful not to exceed 50°C(122°F) of the oil temperature.

9. Using a TORX wrench, install the filler plug.

Tightening torque : 35 Nm(3.5 kgf.m, 25.3lb-ft)

Procedure Of ATF Level Adjustment

1. Park the vehicle on a flat load and lock the tires.
2. Shift the shift lever to "P" range.
3. Using a TORX wrench, remove the filler plug (A).

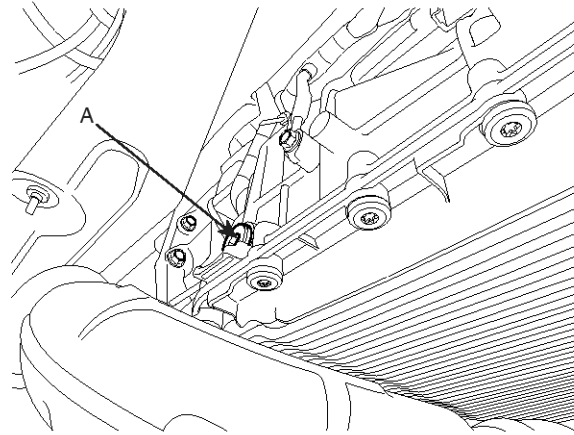

SHMAA9001N

4. If ATF does not drop, add ATF until it drops.

Specified ATF : Shell M-1375.4

5. Using a TORX wrench, install the filler plug.

Tightening torque : 35 Nm(3.5 kgf.m, 25.3lb-ft)

6. Start the engine.
7. Shift through all ranges (P-R-N-D-3). Stay in each range for more than 3 seconds.
Then return to "P".

NOTICE

Use the sport mode to shift to "3".

8. Wait until ATF temperature has reached at 30~35°C(86~95°F).

CAUTION

Do not raise ATF temperature by "Stall test"

9. Using a TORX wrench (8mm), remove the filler plug.
10. Check for ATF flow from the overflow hole. Add ATF as needed until fluid flows from the overflow hole.

Specified ATF : Shell M-1375.4

11. Check that the ATF flows out of the overflow hole at 30~50°C(86~122°F).

CAUTION

Be careful not to exceed 50°C(122°F) of the oil temperature.

12. Using a TORX wrench, install the filler plug.

Tightening torque : 35 Nm(3.5 kgf.m, 25.3lb-ft)

Automatic Transaxle System

ATA-9

TCU Terminal Description

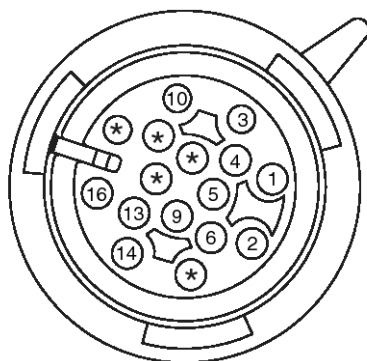

SHMAA9004N

Terminal	Name	Terminal	Name
1	Select Switch	9	ON/START Input
2	CAN-Low	10	Start Relay
3	K-Line	11-12	-
4	Down Switch	13	Ground
5	Up Switch	14	Memory Power
6	CAN-High	15	-
7-8	-	16	Ground

اولین سامانه دیجیتال تعمیرکاران خودرو در ایران

ATA-10

Automatic Transaxle System

Automatic Transaxle

Components

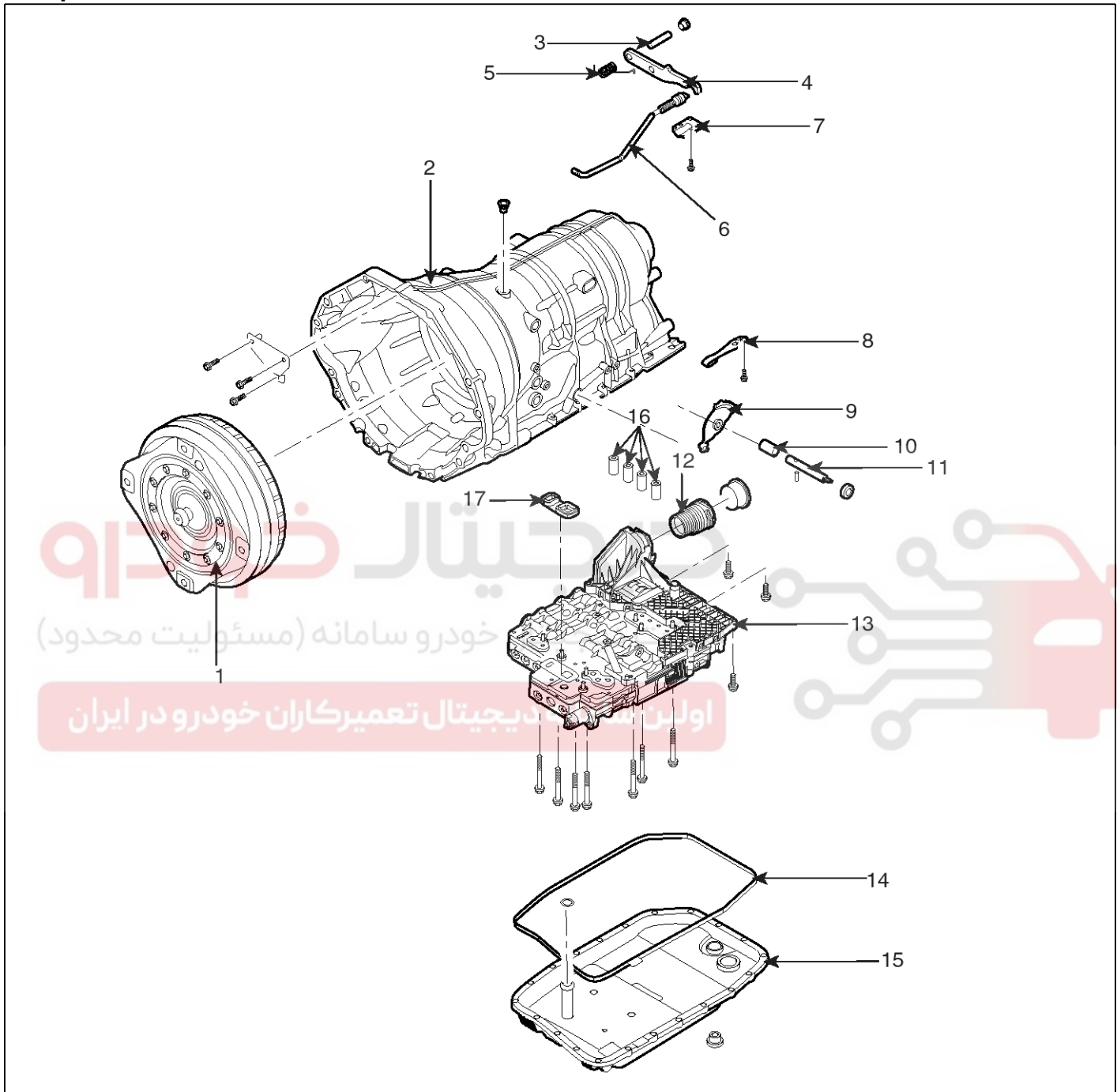

SHMAT8034D

- 1. Torque converter assembly
- 2. Transmission assembly
- 3. Pin
- 4. Ratchet
- 5. Torsion spring
- 6. Connectingrod

- 7. Guide plate
- 8. Detent spring
- 9. Detent disc
- 10. Shaft seal ring
- 11. Selector shaft
- 12. Shield cap

- 13. Mechatroni
- 14. Oil pan gasket
- 15. Oil pan
- 16. Oil seal
- 17. Adapter

Automatic Transaxle System

ATA-11

Removal

[Diesel 3.0]

1. Disconnect the battery (-) terminal.

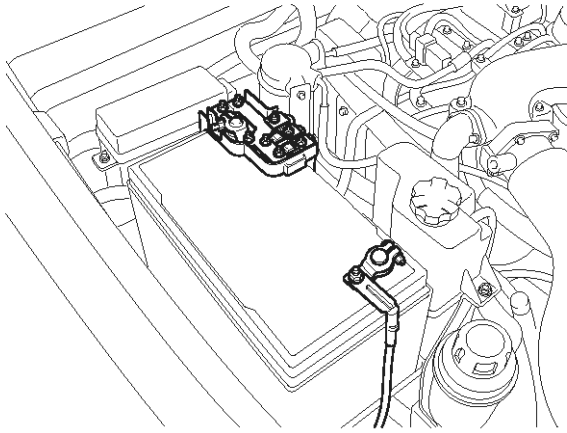

SHMAT8001D

2. Remove the rear propeller shaft. (refer to Propellar shaft in DS group)
3. Support the transaxle with a jack

CAUTION

Be careful not to give a shock or damage to the plastic oil pan.

4. Remove the cross member (A) by removing the bolts (8ea).

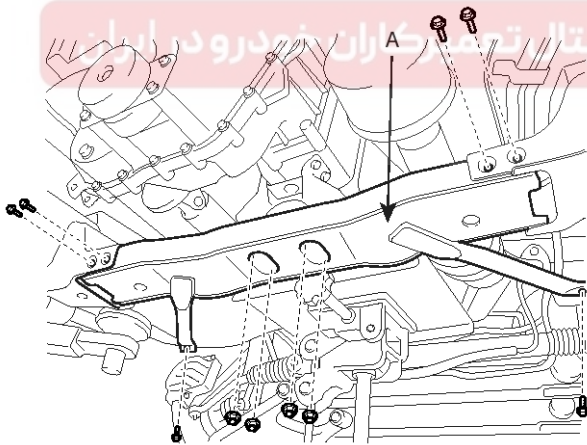

SHMAT8002D

5. Remove the insulator support bracket (A).

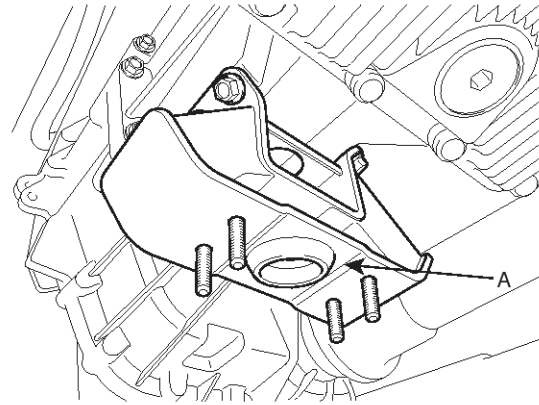

SHMAT8003D

6. Remove the transfer front propeller shaft. (refer to Propellar shaft in DS group)
7. After pulling out the clip (A) and removing the snap pin and washer, remove the shift cable (B) from the transmission case.

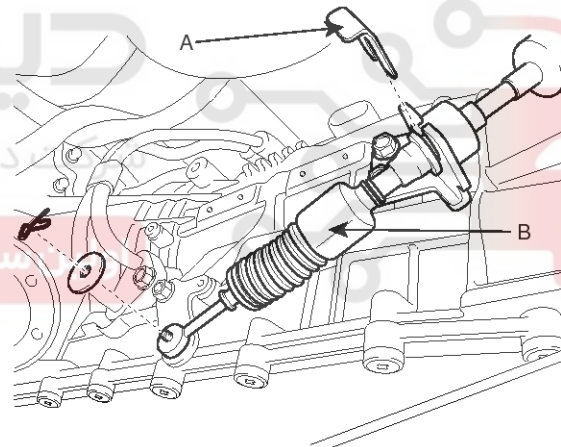

SHMAT8004D

ATA-12

Automatic Transaxle System

8. Disconnect the 4WD ECU connector (A) or EMC connector (B).

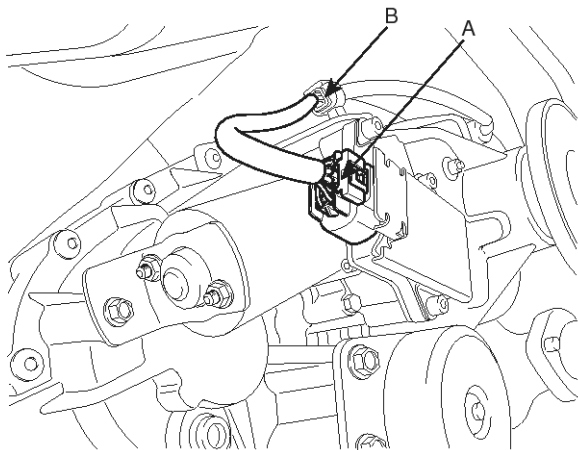

SHMAT8005D

9. Remove the mounting bolts (8ea) and the transfer assembly.

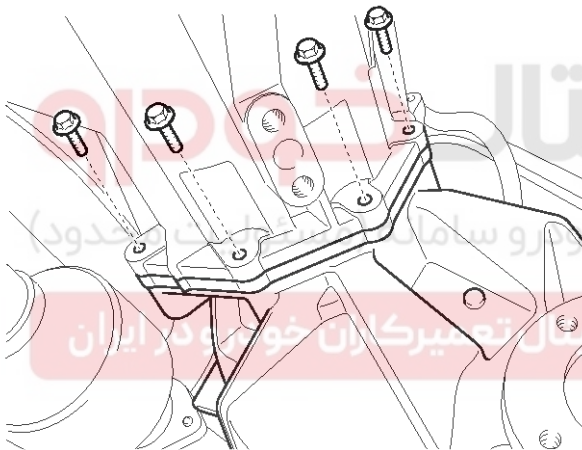

SHMAT8006D

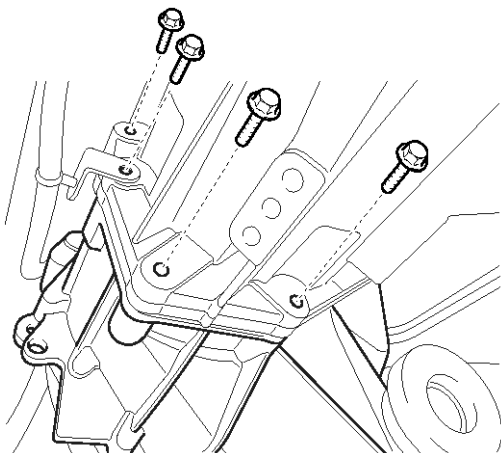

SHMAT8007D

10. Remove the ground wire (A) by removing the bolt.

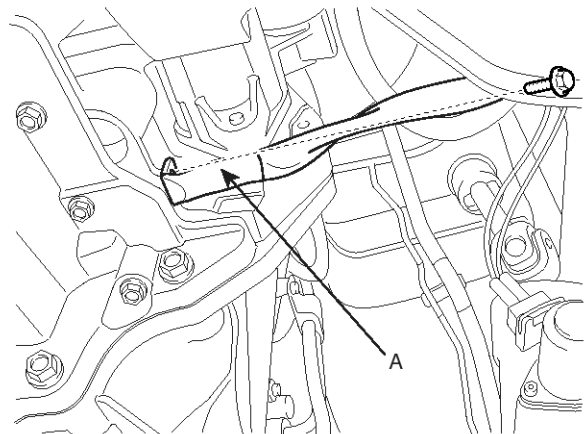

SHMAT8008D

11. Disconnect the TCU connector (A).

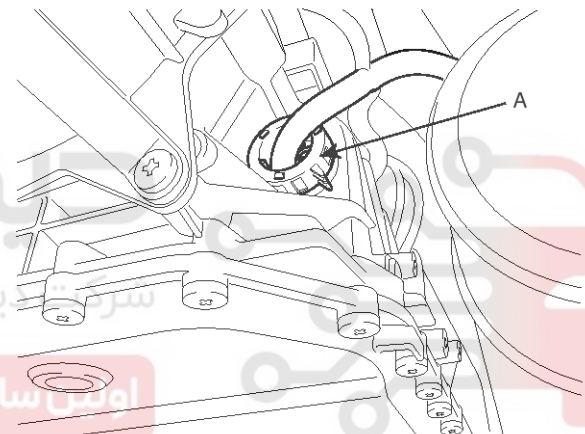

SHMAT8009D

12. Remove the oil cooler hoses by loosening the clamps.

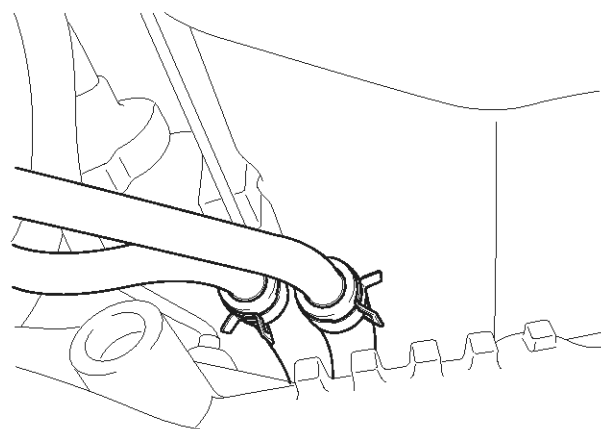

SHMAT8011D

Automatic Transaxle System

ATA-13

13. Remove the wire holding brackets on the transmission.

14. Remove the muffler mounting bracket (A) by removing the bolts (B-2ea, C-2ea).

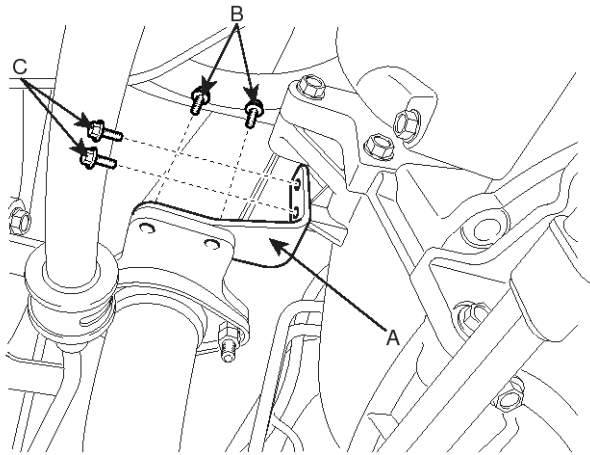

SHMAT8014D

15. Remove the dust cover (A).

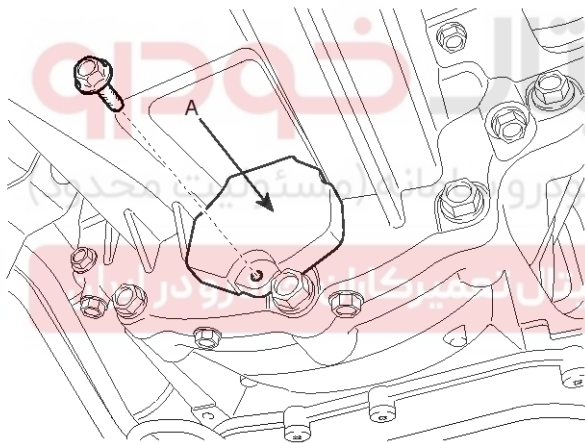

SHMAT8012D

16. Remove the torque converter mounting bolts (A-6ea) by rotating the crank shaft.

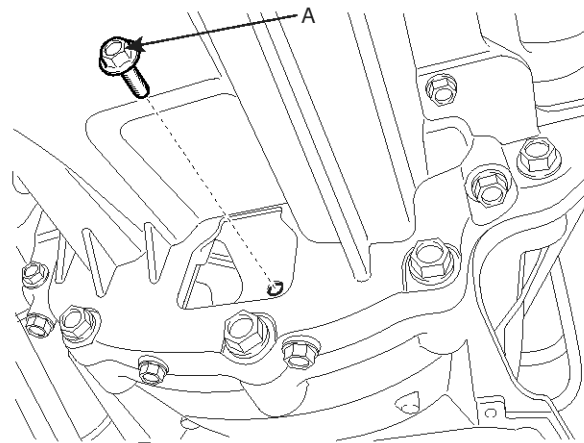

SHMAT8013D

17. Remove the mounting bolts (A-5ea) lower in the engine side.

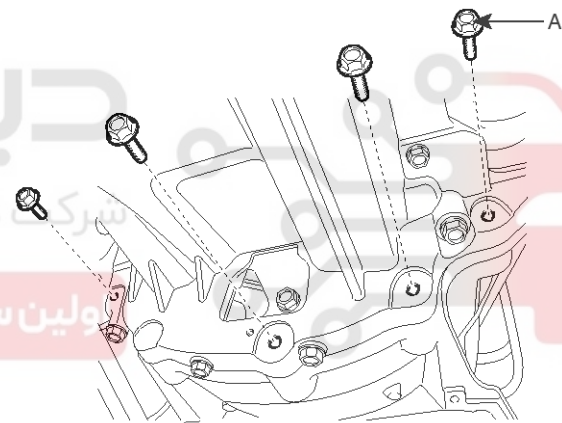

SHMAT8015D

18. Remove the transmission mounting bolts (A,B) and the starter motor mounting bolts (C-2ea).

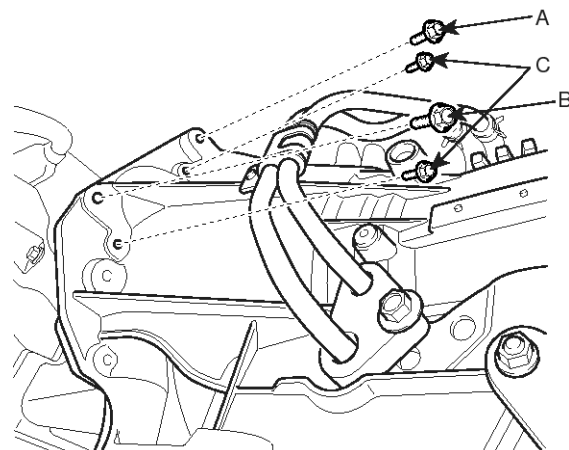

SHMAT8010D

ATA-14

Automatic Transaxle System

19. Remove the transmission mounting bolts (3ea) from the engine side.

NOTICE

When removing the lowest bolt, it interferes with the engine support bracket.

But there is no problem to disassemble the transmission from the engine.

20. Remove the transmission upper mounting bolts (2ea).

CAUTION

Be careful not to damage the tube for engine coolant.

21. Disconnect the CKP sensor (A).

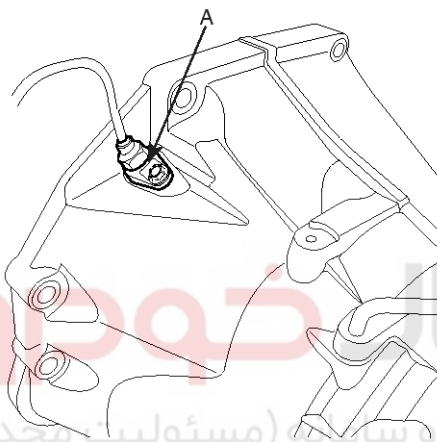

SHMAT8013L

22. Remove the transmission assembly by lowering the supporting jack.

CAUTION

Be careful not to damage tubes, hoses or wire.

[Gasoline 4.6]

1. Disconnect the battery (-) terminal.

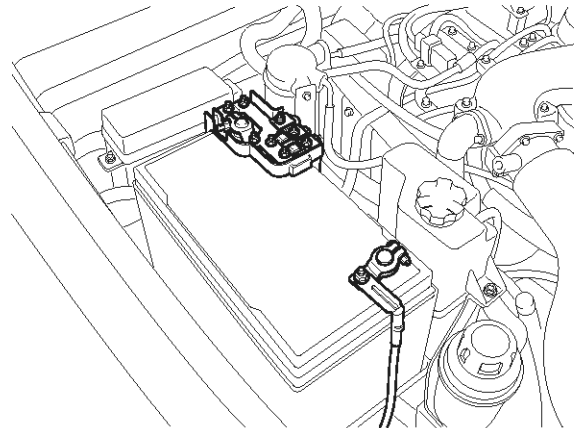

SHMAT8001D

2. Remove the rear propeller shaft. (refer to Propeller shaft in DS group)
3. Support the transaxle with a jack.

CAUTION

Be careful not to give a shock or damage to the plastic oil pan.

4. Remove the muffler assembly. (refer to Muffler in EM group)
5. Remove the cross member (A) by removing the bolts (8ea).

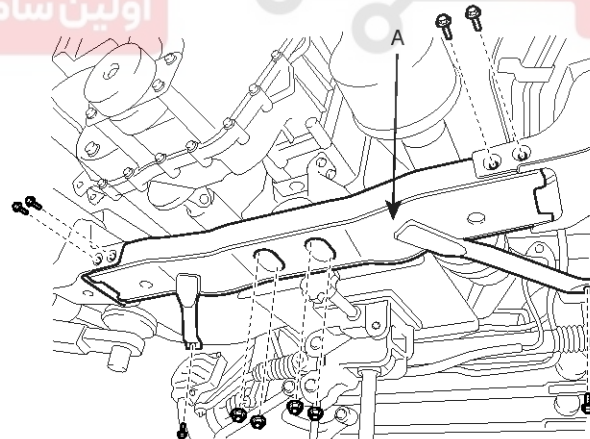

SHMAT8002D

Automatic Transaxle System

ATA-15

6. Remove the insulator support bracket (A).

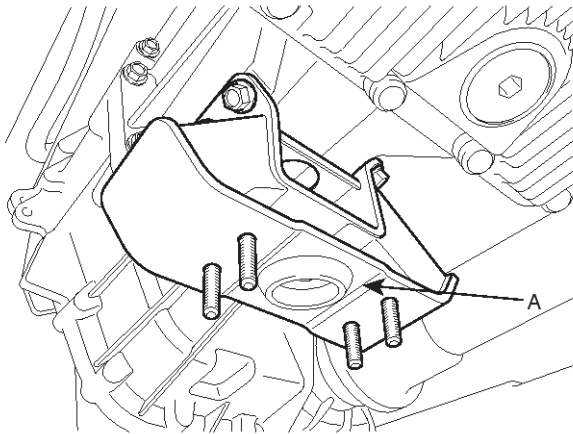

SHMAT8020L

7. Remove the transfer front propeller shaft. (refer to Propellar shaft in DS group)

8. Disconnect the shift cable assembly (A).

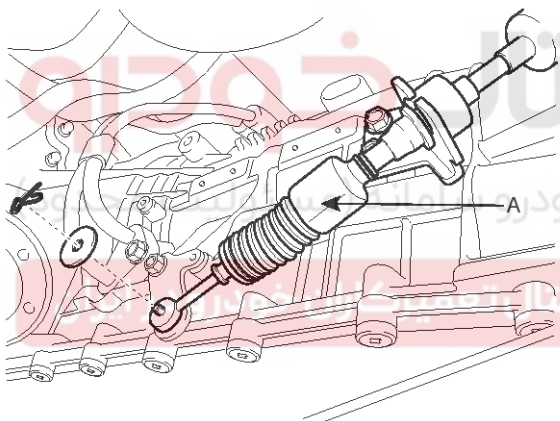

SHMAT8021L

9. Disconnect the 4WD ECU connector (A) or EMC connector (B).

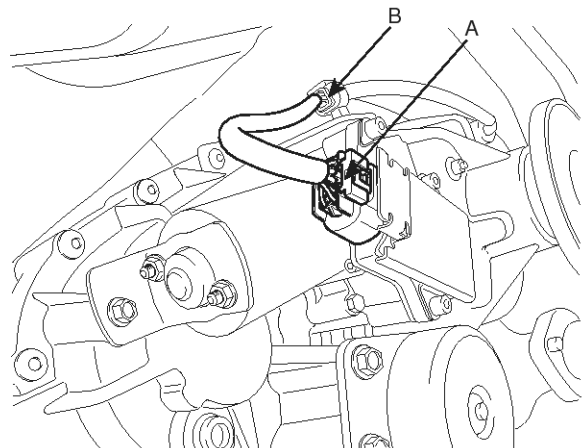

SHMAT8005D

10. Remove the mounting bolts (8ea) and the transfer assembly.

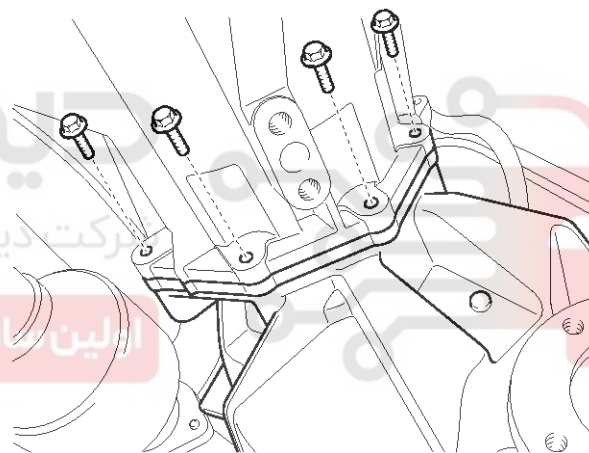

SHMAT8006D

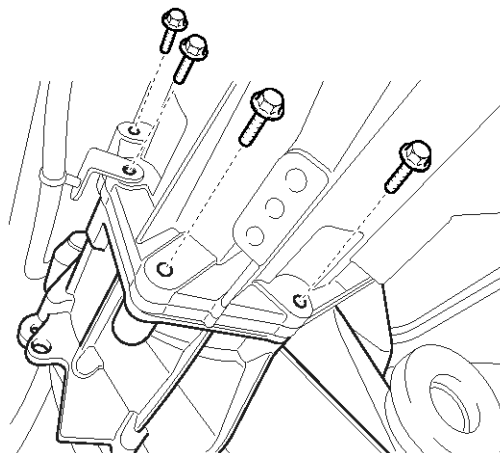

SHMAT8007D

ATA-16

Automatic Transaxle System

11. Remove the ground wire (A) by removing the bolt.

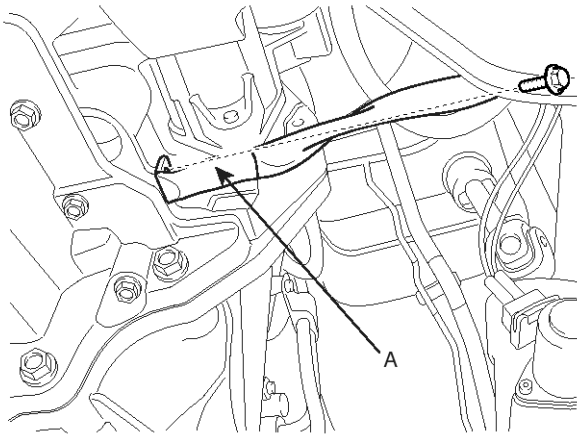

SHMAT8008D

12. Remove the exhaust manifold stay (A).

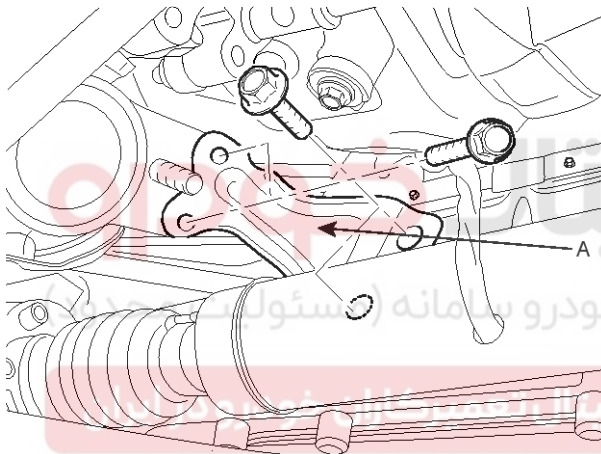

SHMAT8006L

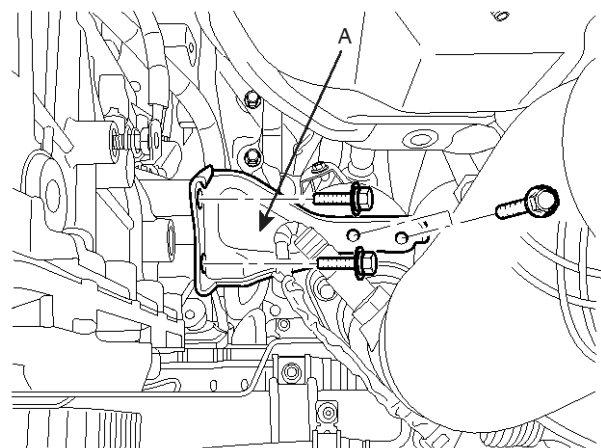

SHMAT8007L

13. Disconnect the TCU connector (A).

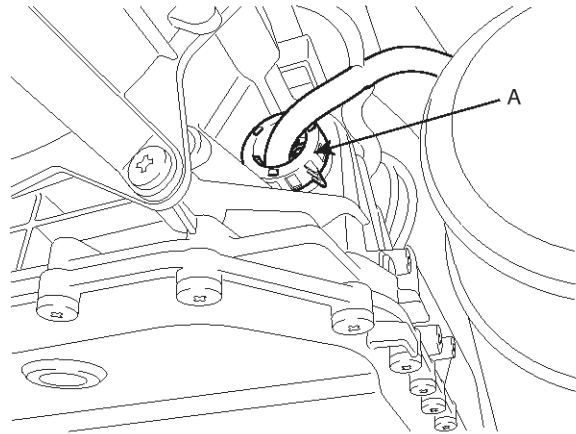

SHMAT8009D

14. Remove the oil cooler hose mounting bolt (A) and the bracket mounting bolt (B).

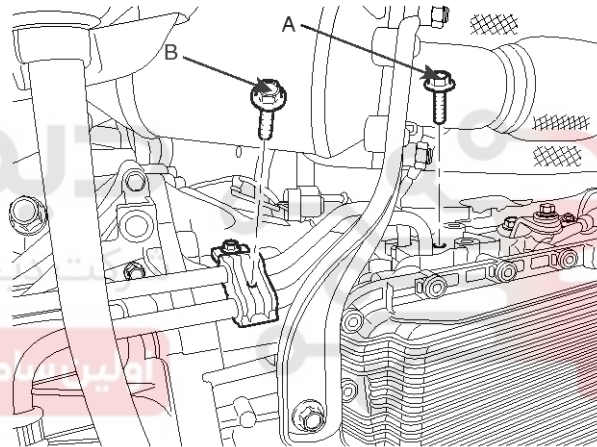

SHMAT8008L

15. Remove the wire holding brackets on the transmission.

Automatic Transaxle System

ATA-17

16. Remove the dust cover (A).

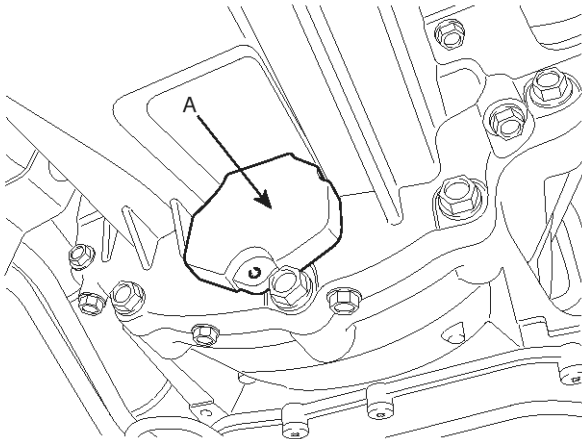

SHMAT8022L

17. Remove the torque converter mounting bolts (A-6ea) by rotating the crank shaft.

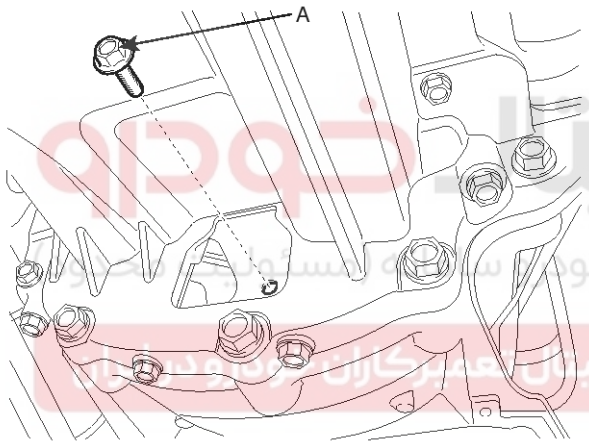

SHMAT8013D

18. Remove the mounting bolts (A-4ea) lower in the engine side.

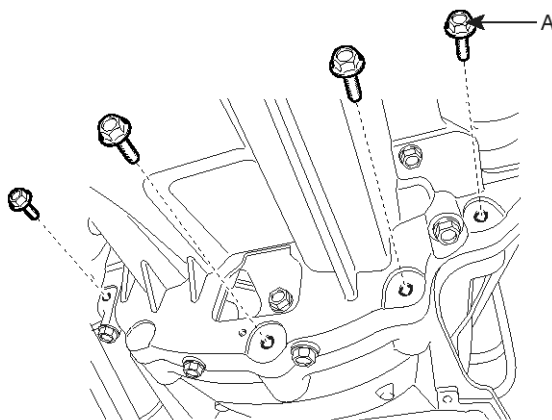

SHMAT8015D

19. Remove the mounting bolts (A-2ea).

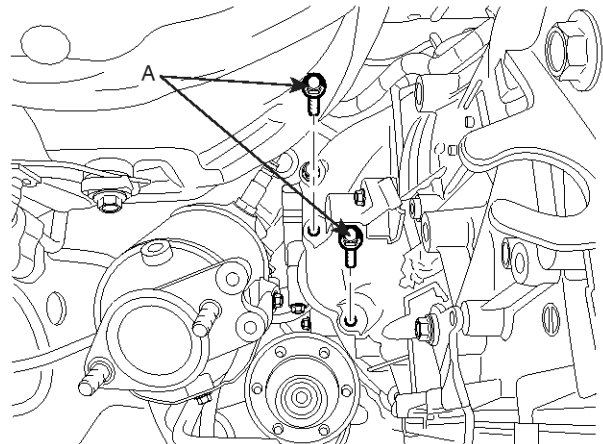

SHMAT8010L

20. Remove the mounting bolts (A-2ea) for the starter motor.

CAUTION

Before removing one mounting bolt on the transmission side and the other bolt for the starter motor, remove the cross member and lower the transmission assembly.

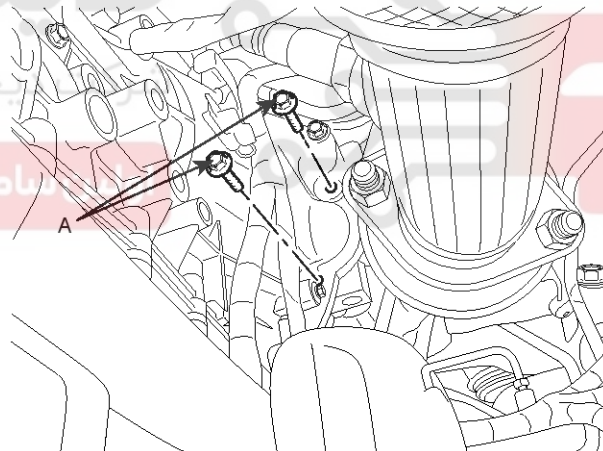

SHMAT8011L

ATA-18

Automatic Transaxle System

21. Remove the mounting bolts (A-4ea) on the transmission side.

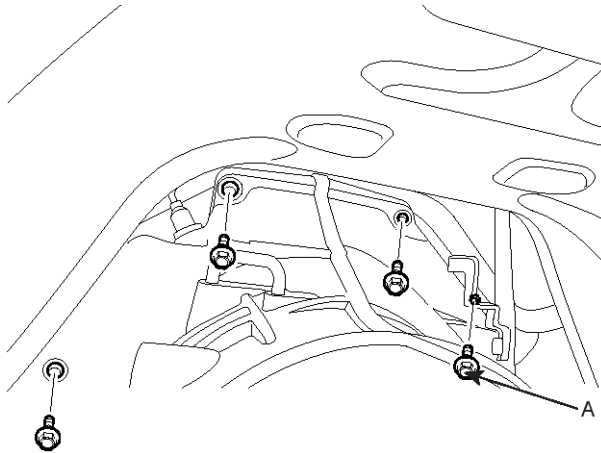

SHMAT8012L

22. Disconnect the CKP sensor (A).

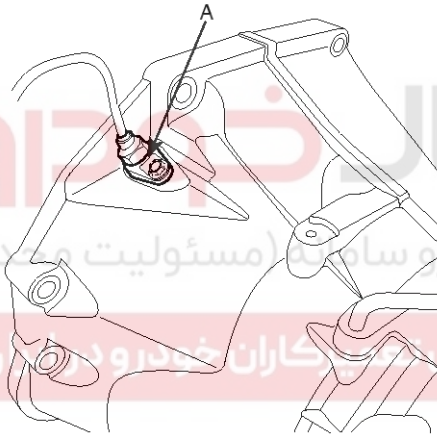

SHMAT8013L

23. Remove the transmission assembly by lowering the supporting jack.

CAUTION

Be careful not to damage tubes, hoses or wire.

Disassembly

1. Drain the ATF by removing the drain plug and retighten the drain plug.
2. Remove the plastic oil pan (A) by removing the special bolts (20ea) with TORX wrench(T40).

CAUTION

Be careful not to drop or damage to the plastic oil pan.

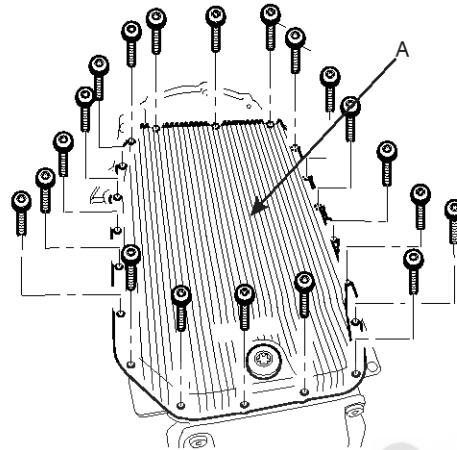

SHMAT8209D

3. After pulling the white clip (A) upward, remove the connector housing (B).

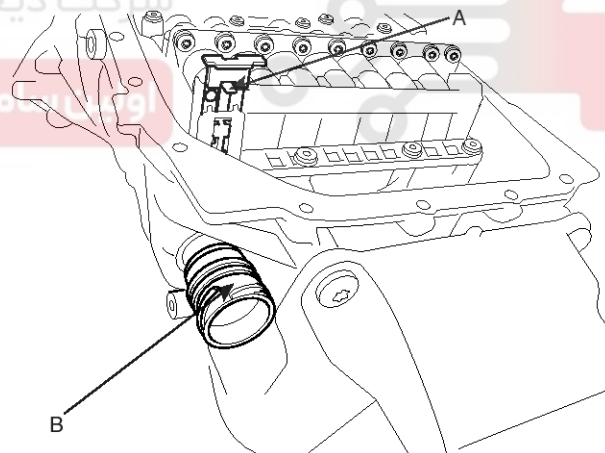

SHMAT8210D

Automatic Transaxle System

ATA-19

- Remove the mechatronik (A) by removing the special bolts (10ea) with TORX wrench(T40).

CAUTION

Be careful not to drop or damage to the mechntronik.

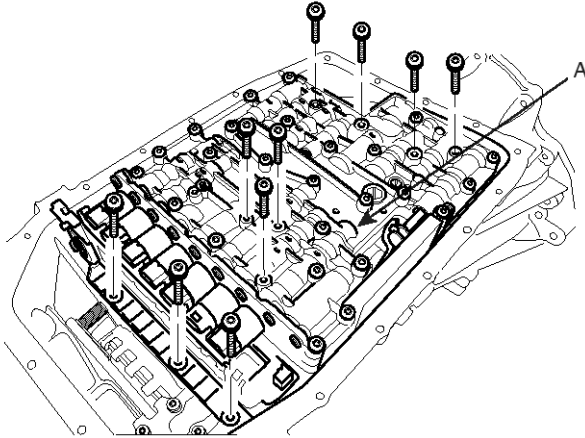

SHMAT8211D

- Remove the adapter (A).

CAUTION

Must use new ones when reassembled.

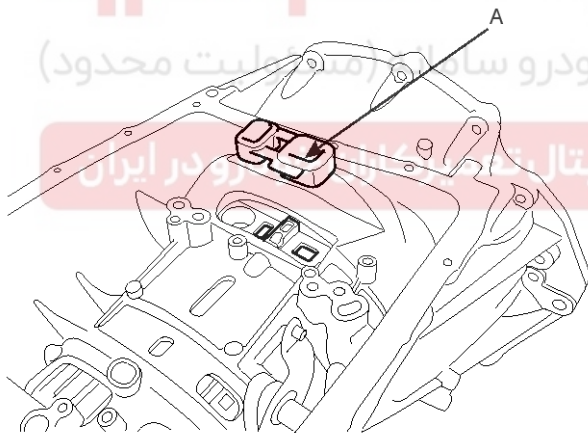

SHMAT8212D

- Remove the selector shaft (A), detent disk (B), and connecting rod (C) by removing the holding pin.

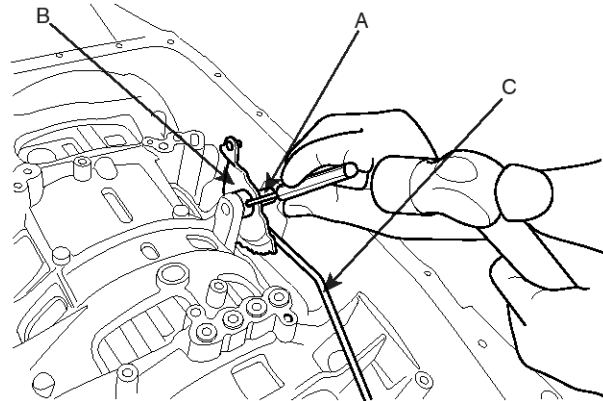

SHMAT8213D

- Remove the guide plate (A) by removing the special bolts (10ea) with TORX wrench(T27).

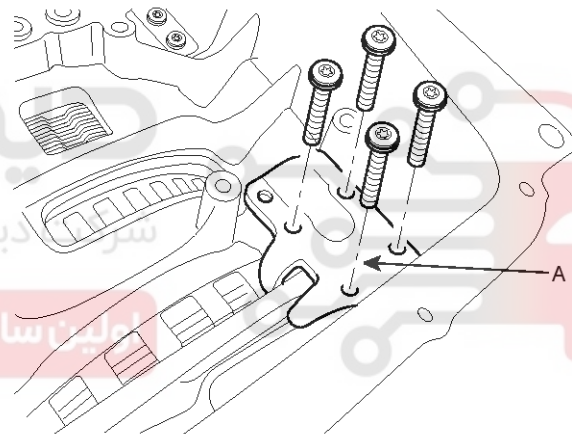

SHMAT8214D

- Remove the spring and ratchet (A) by pushing out the guide pin.

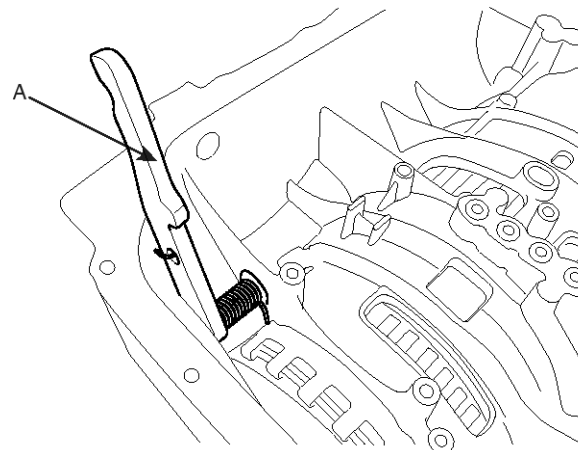

SHMAT8215D

ATA-20

Automatic Transaxle System

9. Pull out the four oil seal (A).

CAUTION

Must use new ones when reassembled.

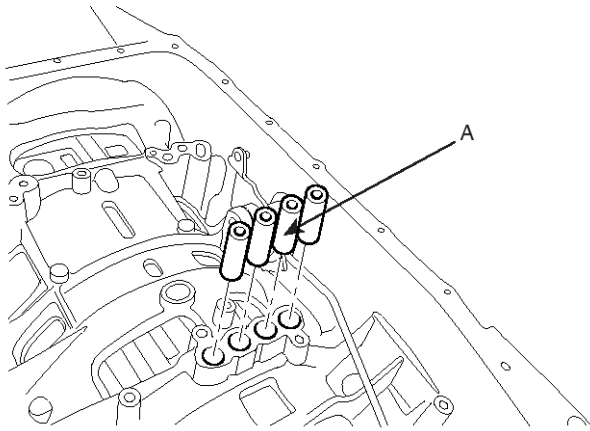

SHMAT8216D

Reassembly

1. Insert the four oil seal (A).

CAUTION

Must use new ones when reassembled.

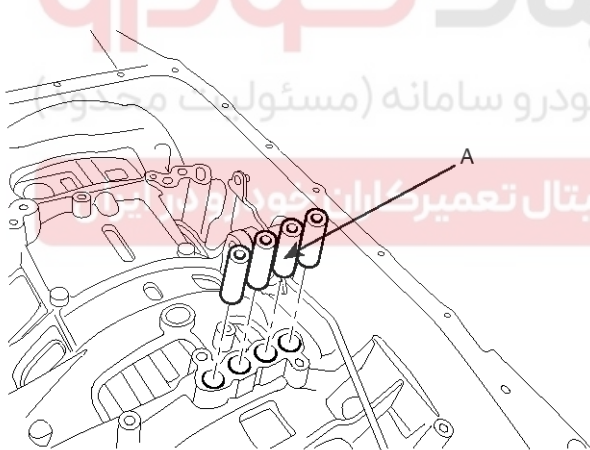

SHMAT8216D

2. Install the spring and ratchet (A) by inserting the guide pin.

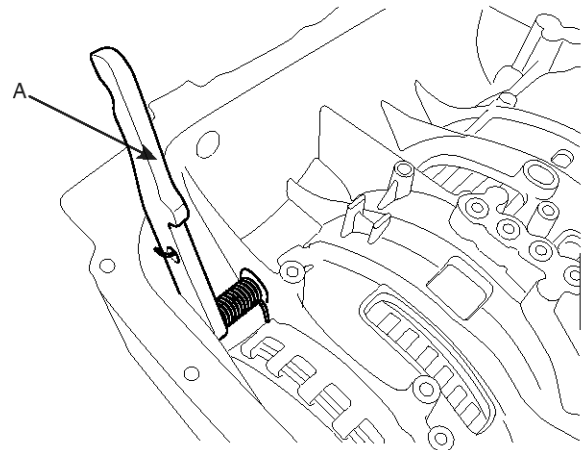

SHMAT8215D

3. Install the guide plate (A) by installing the special bolts (10ea) with TORX wrench(T27).

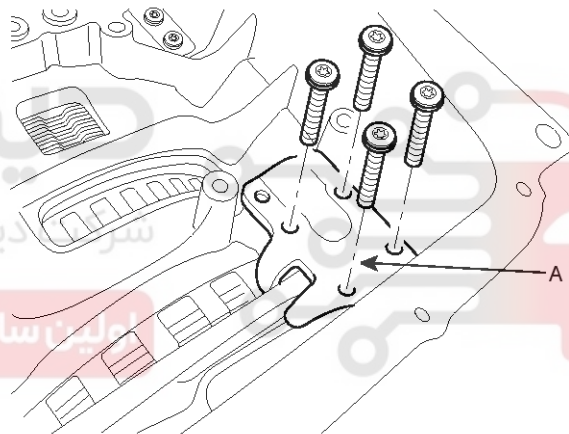

SHMAT8214D

4. Install the selector shaft (A), detent disk (B), and connecting rod (C) by installing the holding pin.

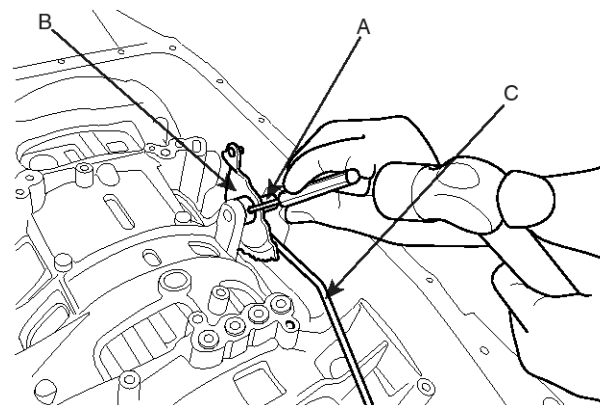

SHMAT8213D

Automatic Transaxle System

ATA-21

5. Install the adapter (A).

CAUTION

Must use new ones when reassembled.

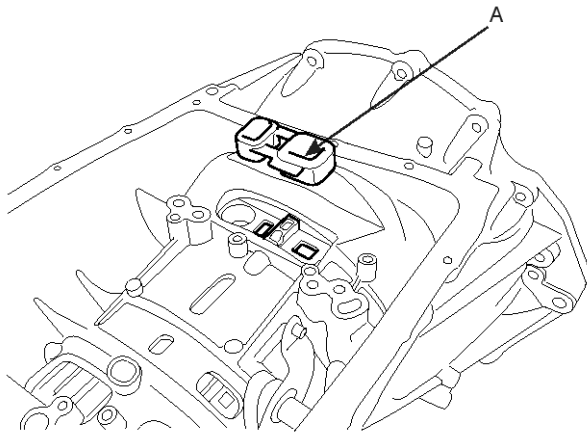

SHMAT8212D

6. Install the mechatronic (A) by installing the special bolts (10ea) with TORX wrench(T40).

CAUTION

Be careful not to drop or damage to the mechntronik.

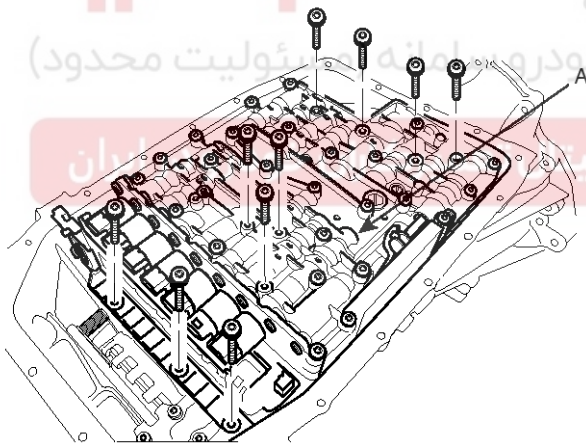

SHMAT8211D

7. After installing the connector housing (B), push the white clip (A) downward.

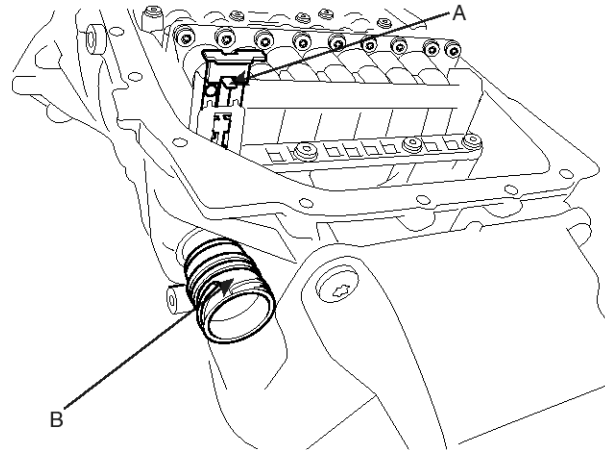

SHMAT8210D

8. Install the plastic oil pan (A) by installing the special bolts (20ea) with TORX wrench(T40).

CAUTION

Be careful not to drop or damage to the plastic oil pan.

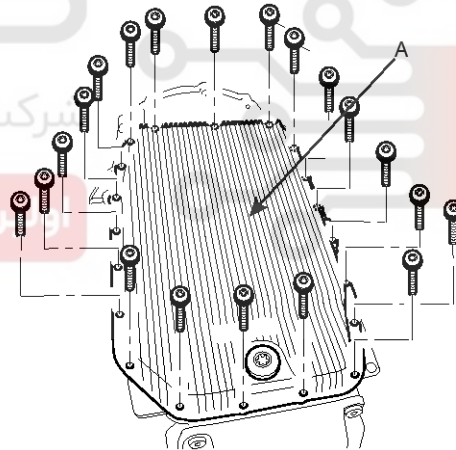

SHMAT8209D

9. Refill the ATF. (refer to Procedure Of ATF Level Adjustment)

ATA-22

Automatic Transaxle System

Installation

[Diesel 3.0]

1. Temporarily install the transmission assembly by lifting the supporting jack.

CAUTION

Be careful not to damage tubes, hoses or wire.

2. Connect the CKP sensor(A).

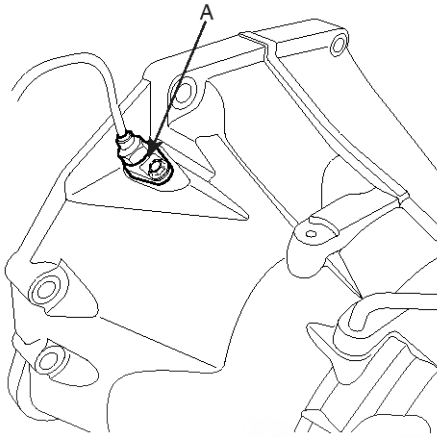

SHMAT8013L

3. Install the transmission upper mounting bolts(2ea).

Tightening torque :

80~100 Nm (8.0~10.0 kgf.m, 57.8~72.3 lb-ft)

CAUTION

Be careful not to damage the tube for engine coolant.

4. Install the transmission mounting bolts (3ea) from the engine side.

Tightening torque :

65~85 Nm (6.5~8.5 kgf.m, 47.0~61.5 lb-ft)

5. Install the transmission mounting bolts (A,B) and the starter motor mounting bolts (C-2ea).

Tightening torque :

B : 80~100 Nm (8.0~10.0 kgf.m, 57.8~72.3 lb-ft)

C : 43~55 Nm (4.3~5.5 kgf.m, 31.1~39.8 lb-ft)

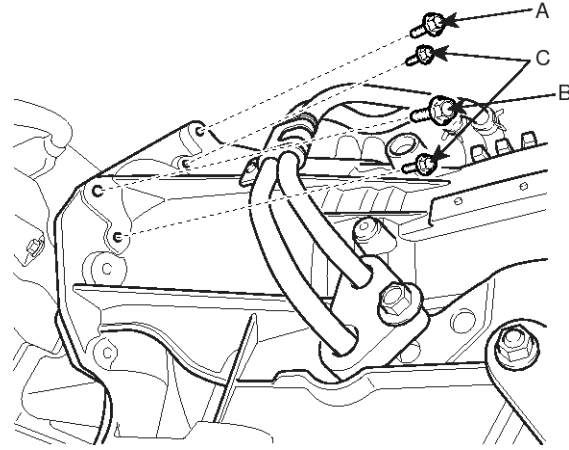

SHMAT8010D

6. Install the mounting bolts (A-5ea) lower in the engine side.

Tightening torque :

40~47 Nm (4.0~4.7 kgf.m, 28.9~33.9 lb-ft)

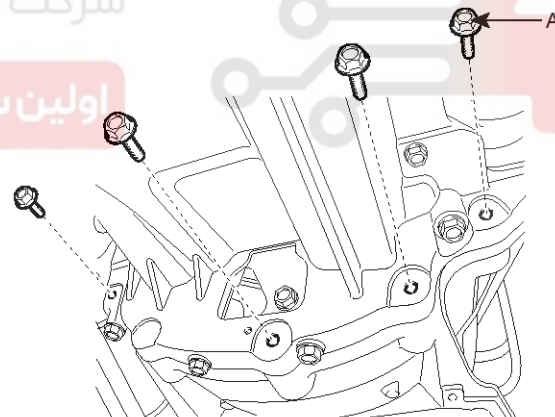

SHMAT8015D

Automatic Transaxle System

ATA-23

7. Install the torque converter mounting bolts (A-6ea) by rotating the crank shaft.

Tightening torque :

46~53 Nm (4.6~5.3 kgf.m, 33.2~38.3 lb-ft)

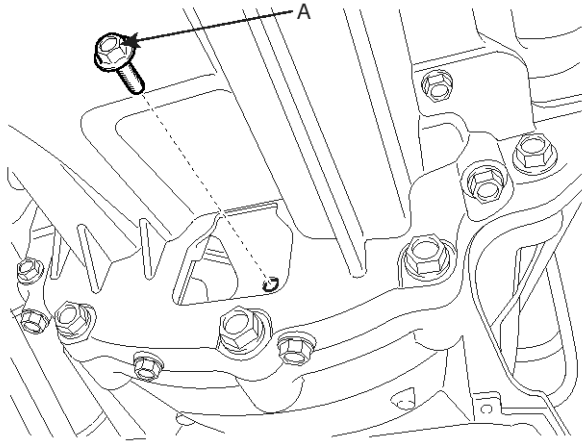

SHMAT8013D

8. Install the dust cover(A).

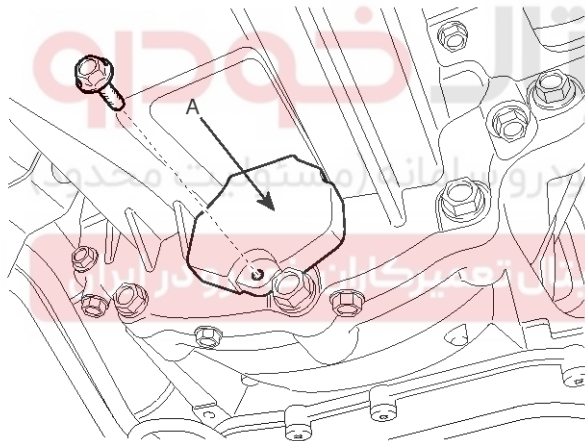

SHMAT8012D

9. Install the wire holding brackets on the transmission.

10. Install the muffler mounting bracket (A) by installing the bolts (B-2ea, C-2ea).

Tightening torque :

B : 41~55 Nm (4.1~5.5 kgf.m, 29.6~39.8 lb-ft)

C : 40~45 Nm (4.0~4.5 kgf.m, 28.9~32.5 lb-ft)

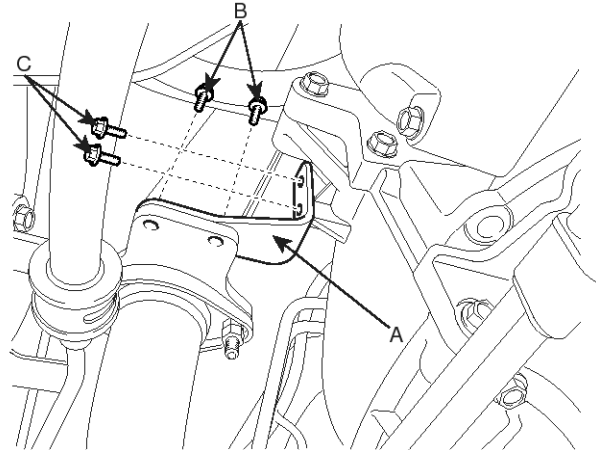

SHMAT8014D

11. Install the oil cooler hoses by tightening the clamps.

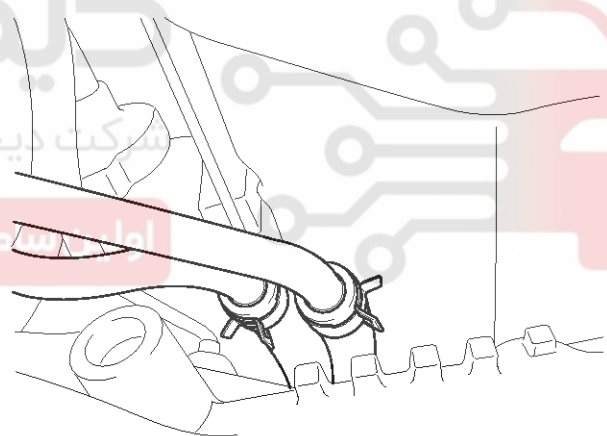

SHMAT8011D

ATA-24

Automatic Transaxle System

12. Connect the TCU connector(A).

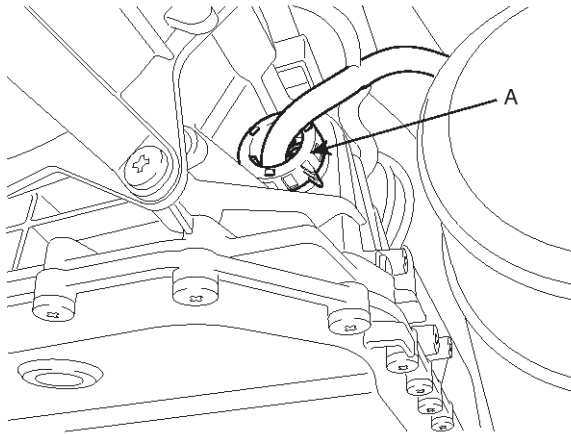

SHMAT8009D

13. Install the ground wire (A) by installing the bolt.



SHMAT8008D

14. Install the mounting bolts(8ea) and the transfer assembly.

Tightening torque :

30~42 Nm (3.0~4.2 kgf.m, 21.6~30.3 lb-ft)

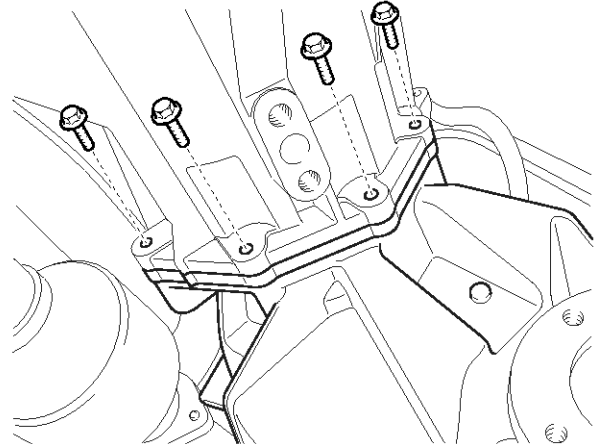

SHMAT8006D

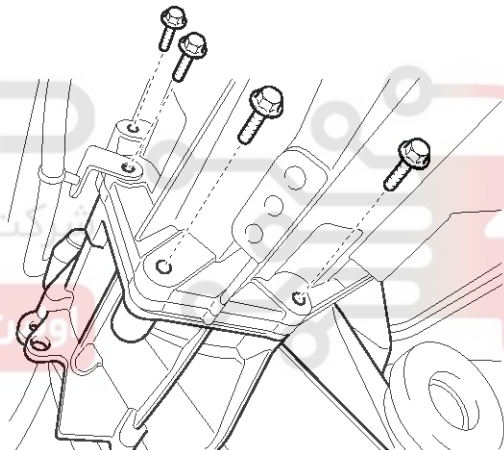

SHMAT8007D

Automatic Transaxle System

ATA-25

15. Connect the 4WD ECU connector (A) or EMC connector (B).

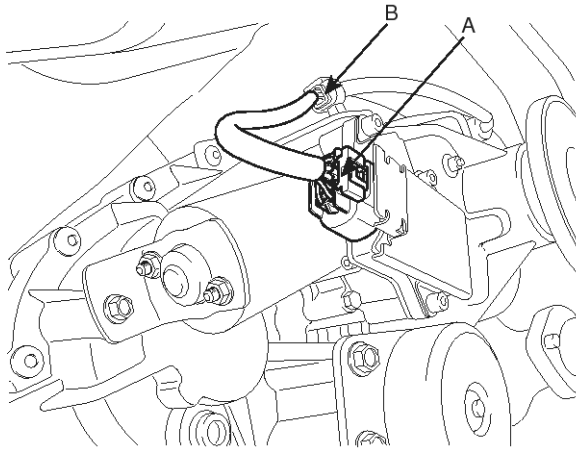

SHMAT8005D

16. Install the shift cable (B) to the transmission case by inserting the clip (A) and installing the snap pin and washer.

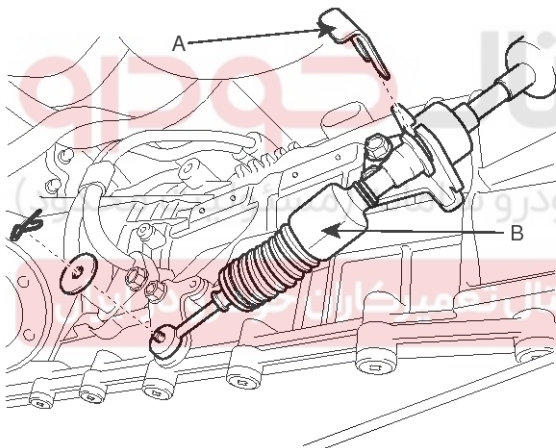

SHMAT8004D

17. Install the transfer front propeller shaft. (refer to Propellar shaft in DS group)

18. Install the insulator support bracket (A).

Tightening torque :

50~65 Nm (5.0~6.5 kgf.m, 36.1~47 lb-ft)

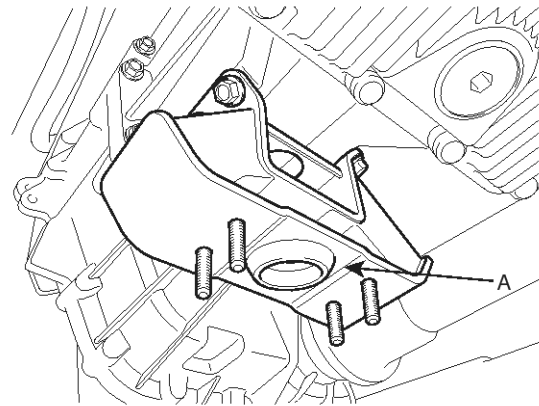

SHMAT8003D

19. Install the cross member (A) by installing the bolts(8ea).

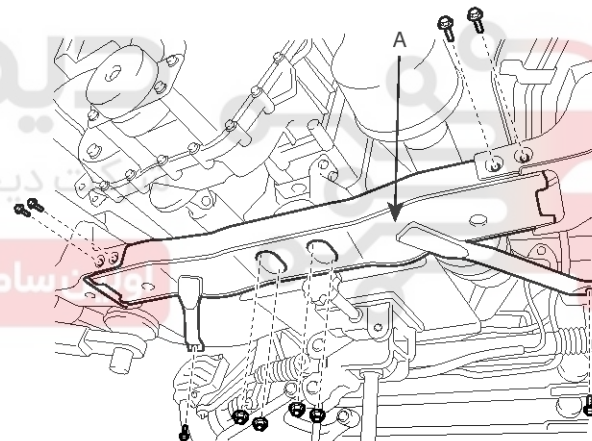

SHMAT8002D

20. Put aside the transmission jack.

21. Install the rear propeller shaft. (refer to Propellar shaft in DS group)

ATA-26

Automatic Transaxle System

22. Connect the battery (-) terminal.

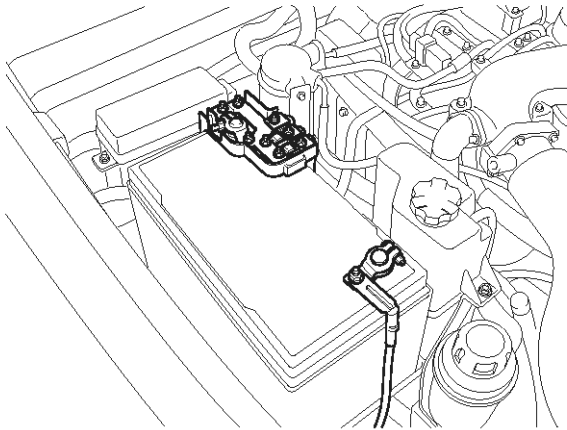

SHMAT8001D

23. Refill the automatic transaxle fluid. (refer to Inspection and Adjustment)

[Gasoline 4.6]

1. Temporarily install the transmission assembly by lifting the supporting jack.

⚠ CAUTION

Be careful not to damage tubes, hoses or wire.

2. Connect the CKP sensor(A).

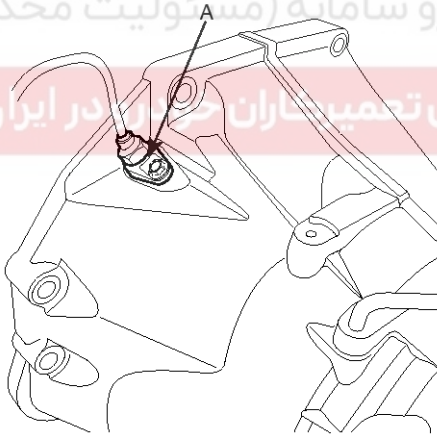

SHMAT8013L

3. Install the mounting bolts (A-2ea, B-2ea) on the transmission side.

Tightening torque :

(A) 80~100 Nm (8.0~10.0 kgf.m, 57.8~72.3 lb-ft)

(B) 63.7~83.4N.m(6.5~8.5kgf.m, 47.0~61.5 lb-ft)

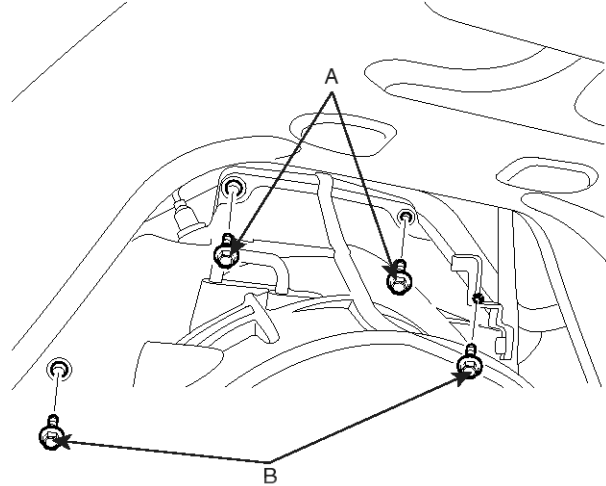

SHMAT8300L

4. Install the mounting bolts (A-2ea) for the starter motor.

Tightening torque :

35~47 Nm (3.5~4.7 kgf.m, 25.3~33.9 lb-ft)

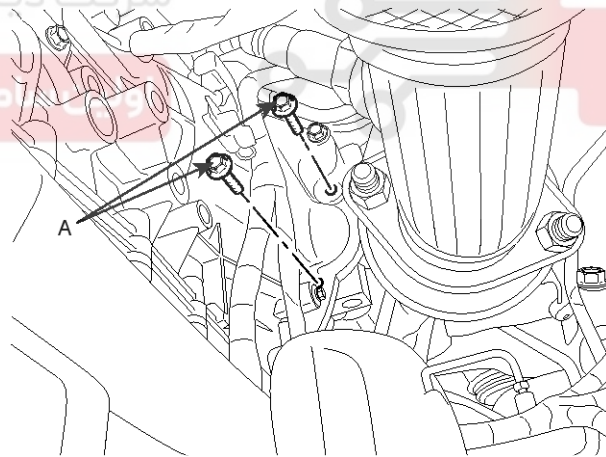

SHMAT8011L

Automatic Transaxle System

ATA-27

5. Install the mounting bolts (A-2ea).

Tightening torque :

35~47 Nm (3.5~4.7 kgf.m, 25.3~33.9 lb-ft)

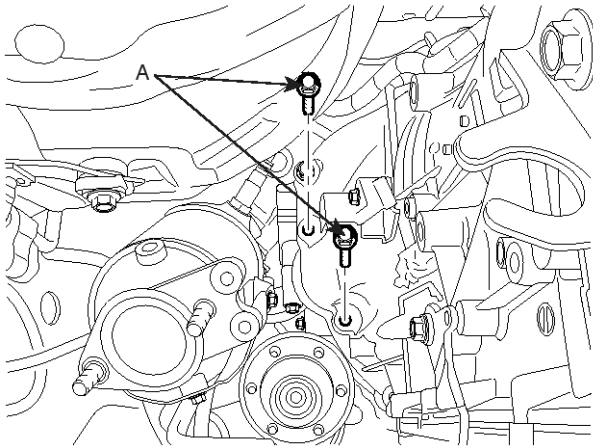

SHMAT8010L

6. Install the mounting bolts (A-4ea) lower in the engine side.

Tightening torque :

40~47 Nm (4.0~4.7 kgf.m, 28.9~33.9 lb-ft)

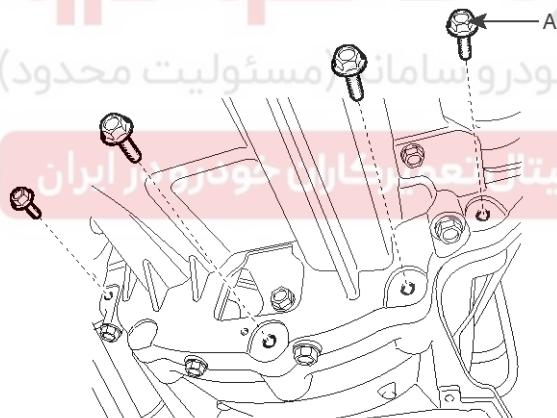

SHMAT8015D

7. Install the torque converter mounting bolts (A-6ea) by rotating the crank shaft.

Tightening torque :

46~53 Nm (4.6~5.3 kgf.m, 33.2~38.3 lb-ft)

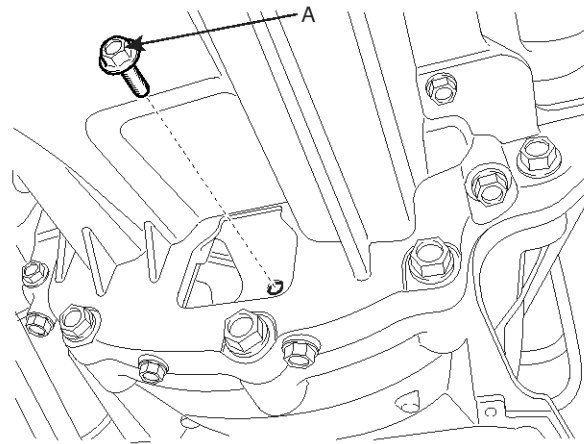

SHMAT8013D

8. Install the dust cover(A).

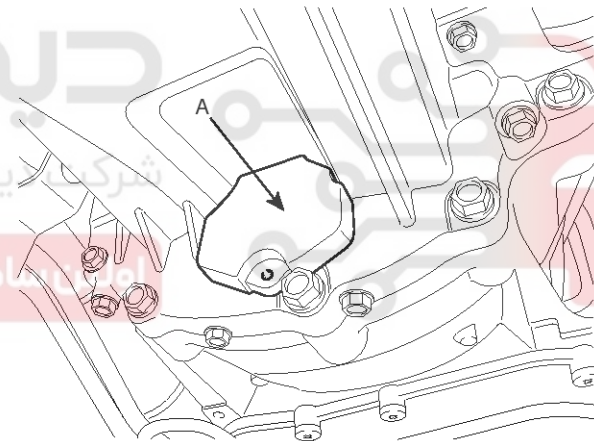

SHMAT8022L

9. Install the wire holding brackets on the transmission.

ATA-28

Automatic Transaxle System

10. Install the oil cooler hose mounting bolt (A) and the bracket mounting bolt (B).

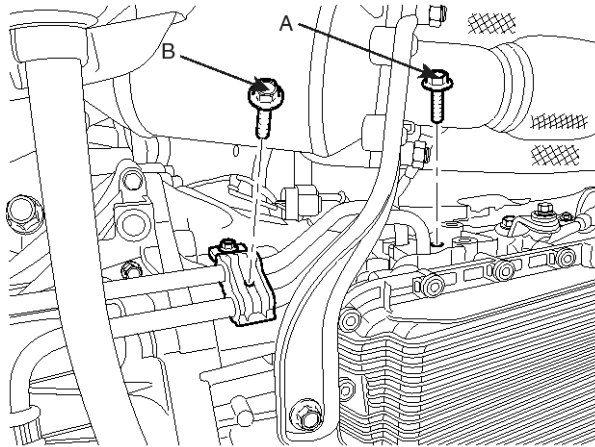

SHMAT8008L

11. Connect the TCU connector(A).

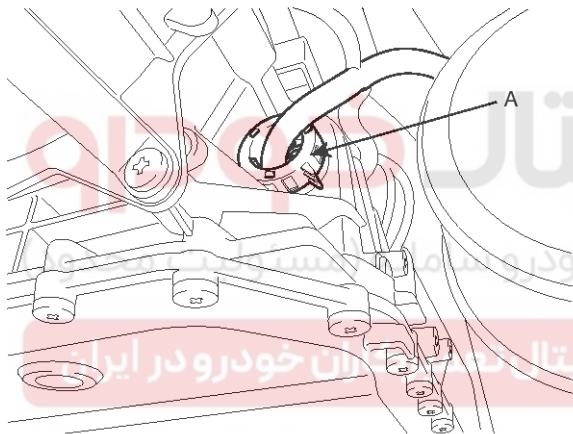

SHMAT8009D

12. Install the exhaust manifold stay (A).

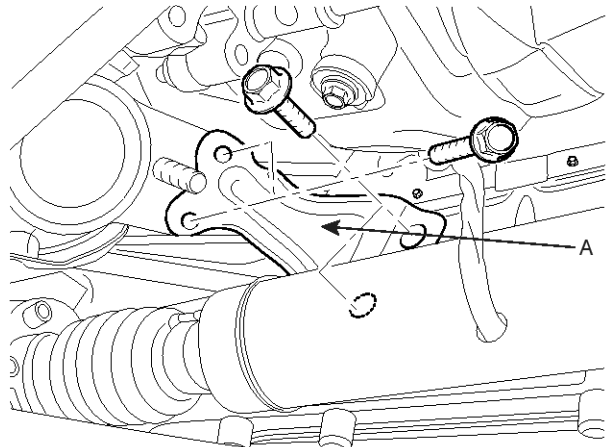

SHMAT8006L

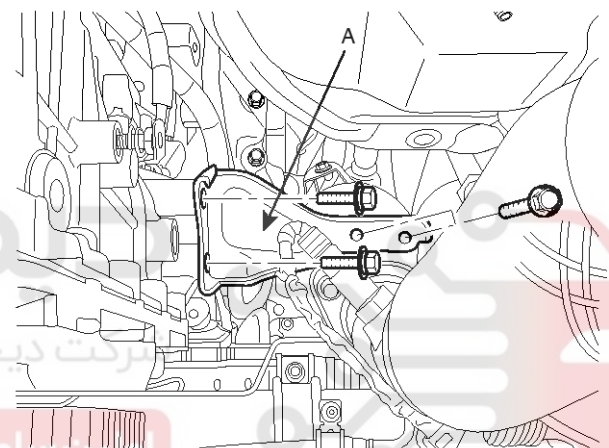

SHMAT8007L

13. Install the ground wire (A) by the bolt.

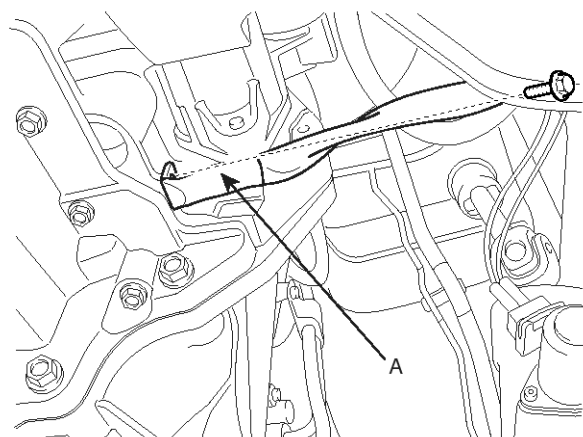

SHMAT8008D

Automatic Transaxle System

ATA-29

14. Install the mounting bolts(A,B-4ea) and the transfer assembly.

Tightening torque :

30~42 Nm (3.0~4.2 kgf.m, 21.6~30.3 lb-ft)

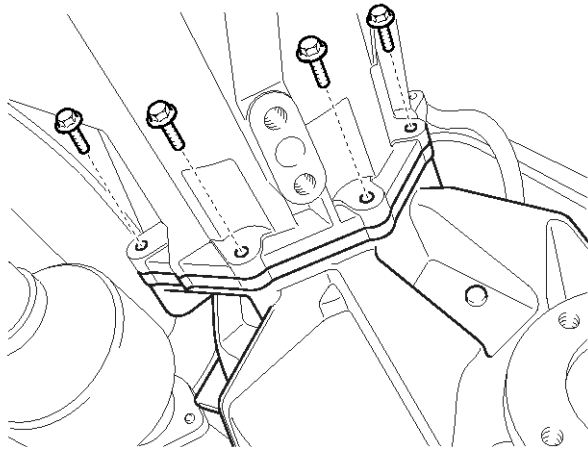

SHMAT8006D

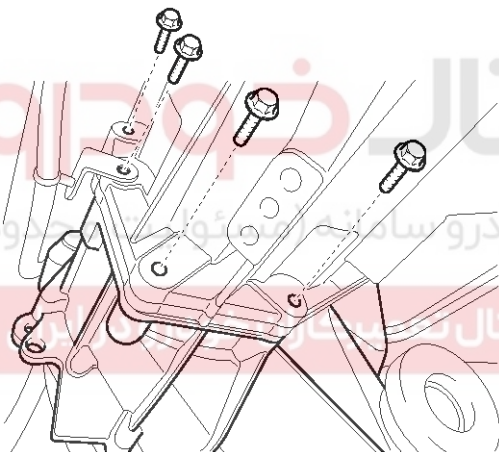

SHMAT8007D

15. Connect the 4WD ECU connector(A) or EMC connector(B).

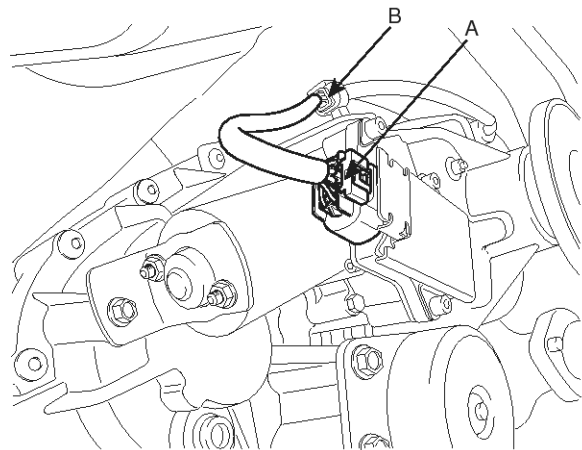

SHMAT8005D

16. Connect the shift cable assembly (A)

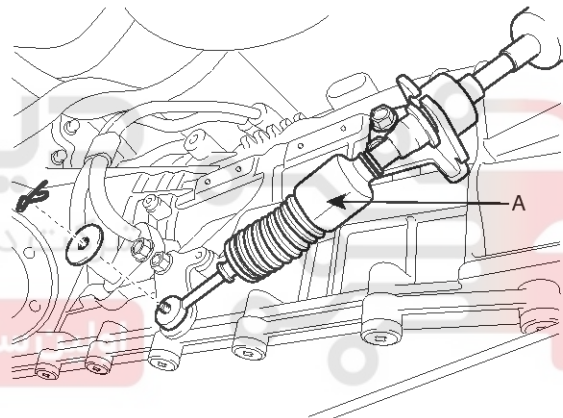

SHMAT8021L

17. Install the cross member(A)

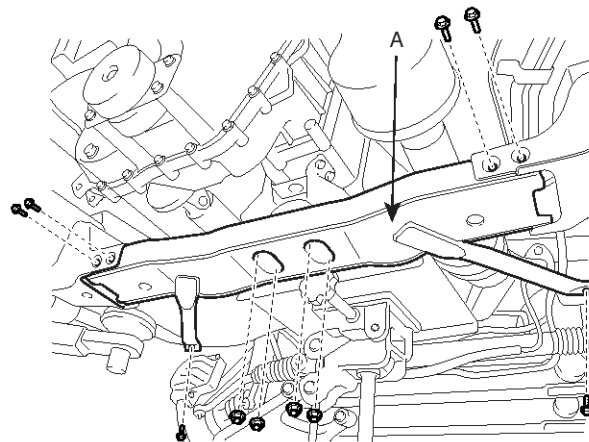

SHMAT8002D

ATA-30

Automatic Transaxle System

18. Install the insulator support bracket(A).

Tightening torque :

50~65 Nm (5.0~6.5 kgf.m, 36.1~47.0 lb-ft)

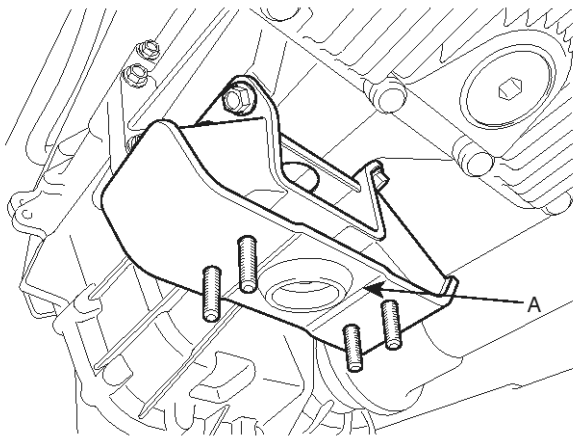

SHMAT8020L

19. Install the cross member (A) by installing the bolts(8ea).

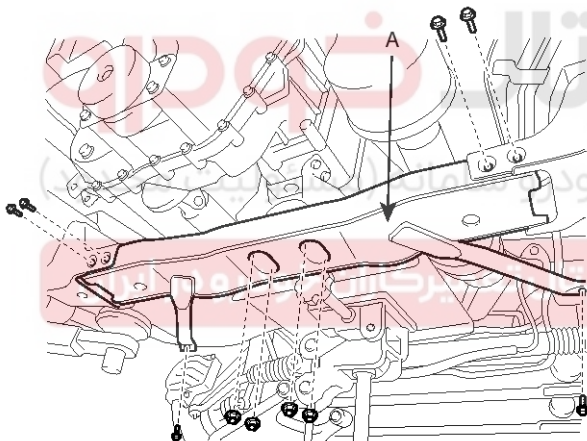

SHMAT8002D

20. Remove the exhaust manifold stay (A).

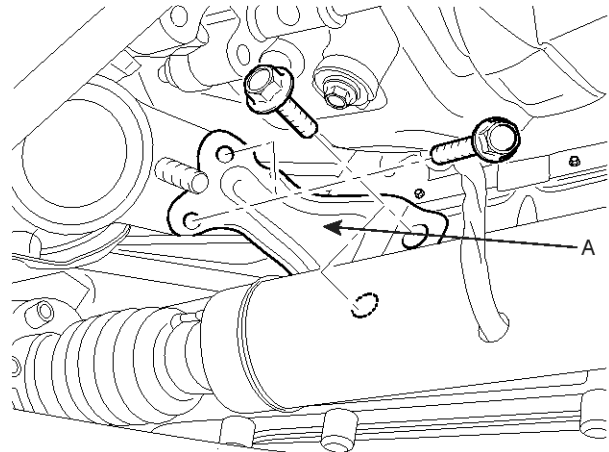

SHMAT8006L

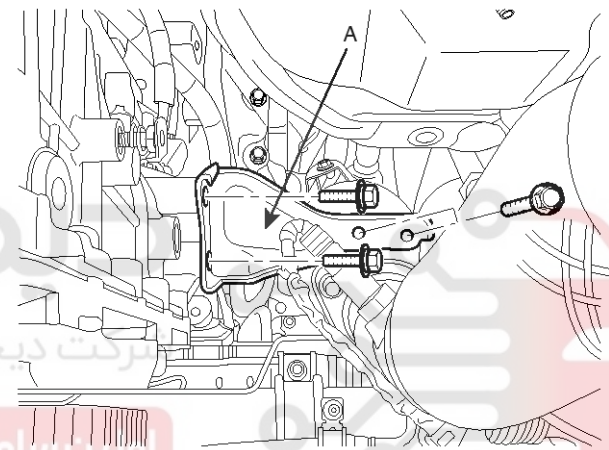

SHMAT8007L

21. Install the muffler assembly. (refer to Muffler in EM group)

22. Put aside the transmission jack.

23. Install the rear propeller shaft. (refer to Propellar shaft in DS group)

Automatic Transaxle System

ATA-31

24. Connect the battery (-) terminal.

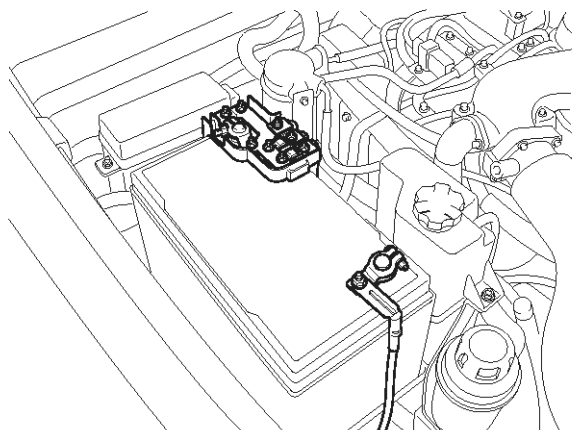

SHMAT8001D

25. Refill the automatic transaxle fluid. (refer to Inspection and Adjustment)

دیجیتال خودرو

شرکت دیجیتال خودرو سامانه (مسئولیت محدود)

اولین سامانه دیجیتال تعمیرکاران خودرو در ایران



ATA-32

Automatic Transaxle System

Automatic Transaxle Control System

Shift Lever

Components

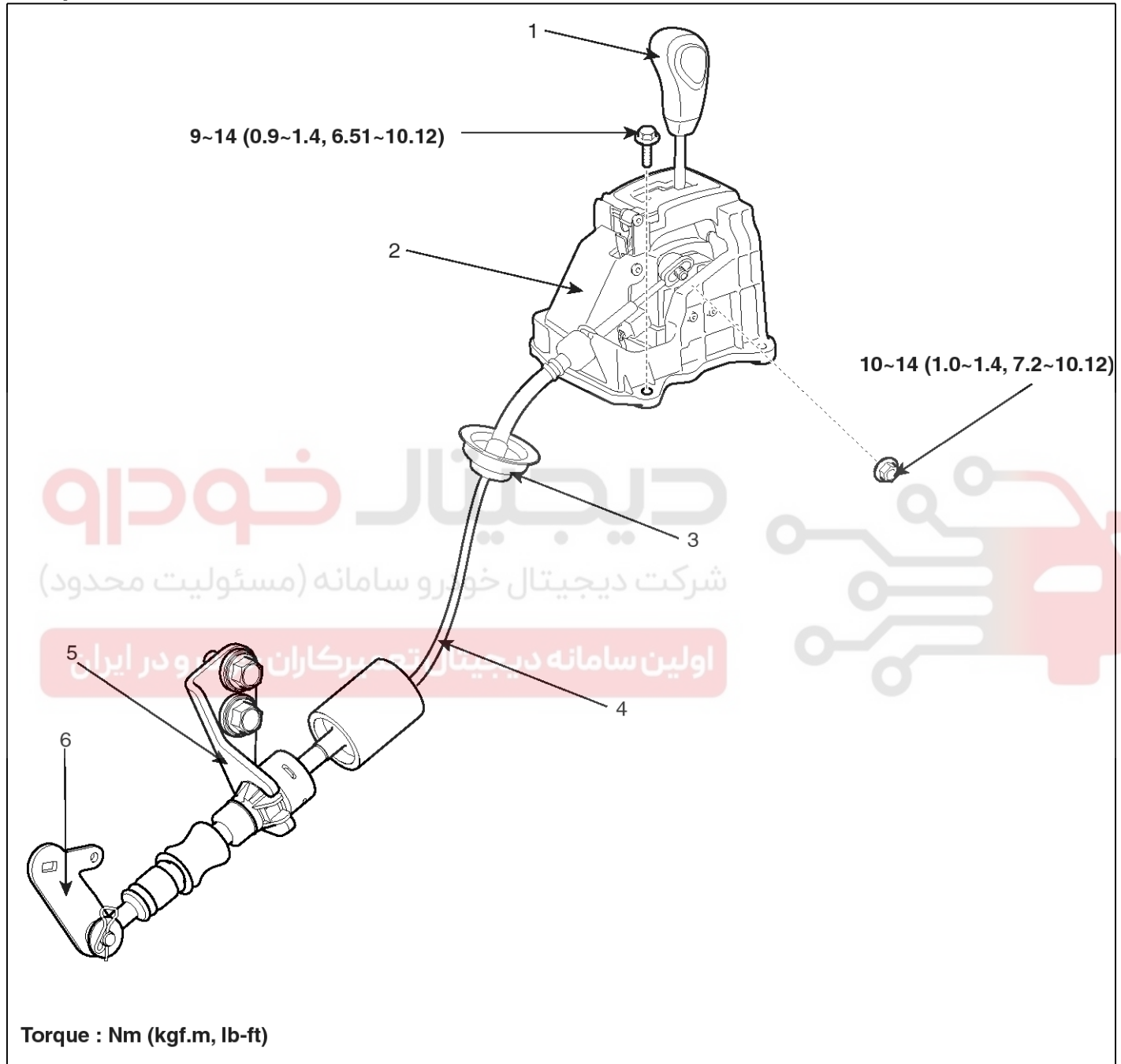

SHMAA9003N

- 1. Shift lever knob
- 2. Shift lever assembly
- 3. Retainer

- 4. Shift cable assembly
- 5. Cable bracket
- 6. Manual lever

Automatic Transaxle Control System

ATA-33

Removal

1. Pull out the shift lever knob (A) in "F" direction.

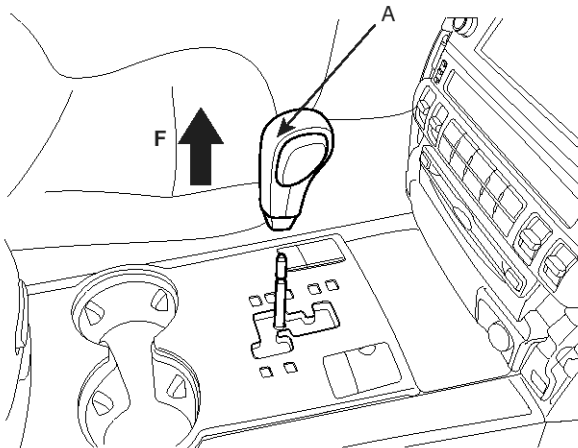

SHMAT8101D

2. Remove the center console cover(A).

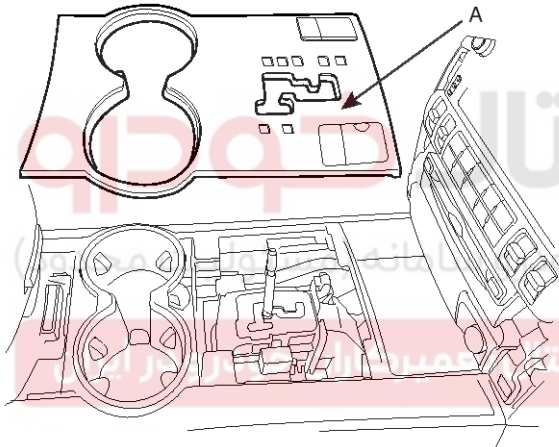

SHMAT8102D

3. Remove the tray(A).

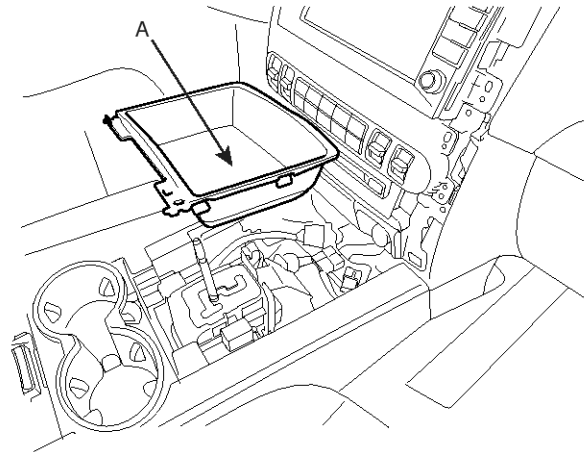

SHMAT8103D

4. Remove the center console(A).(refer to Console in DS group)

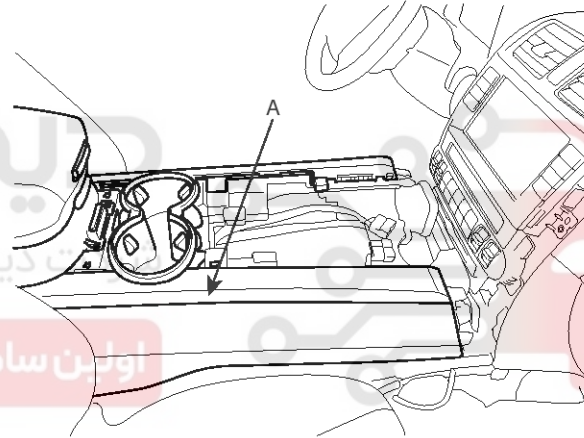

SHMAT8104D

ATA-34

Automatic Transaxle System

5. After removing the control cable nut (A), remove the shift cable in the 'F' direction by pulling the clip (B) on the floor.

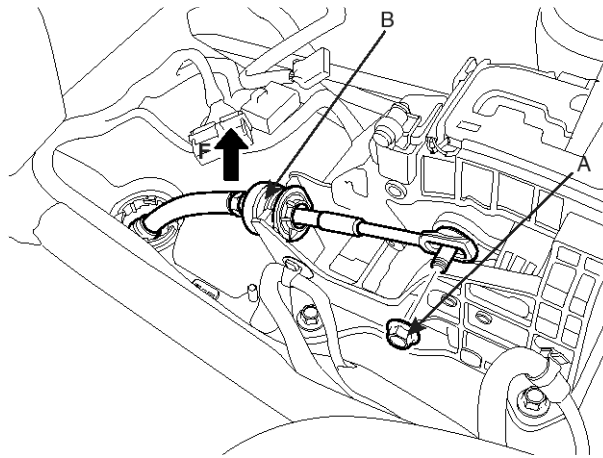

SHMAT8109L

6. Disconnect the sport mode connector (A).

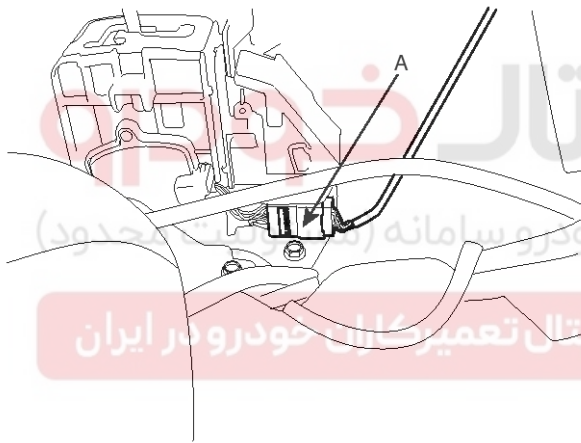

SHMAT8106D

7. Remove the shift lever assembly (B) by removing the four bolts(A).

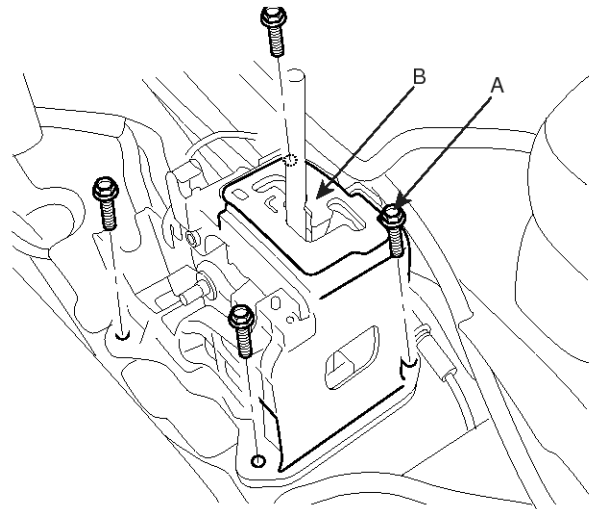

SHMAT8108D

8. Disconnect the shift cable assembly (A)

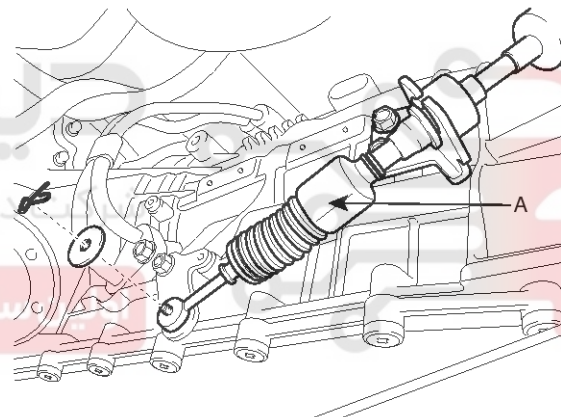

SHMAT8021L

Automatic Transaxle Control System

ATA-35

Installation

1. Connect the shift cable assembly (A)

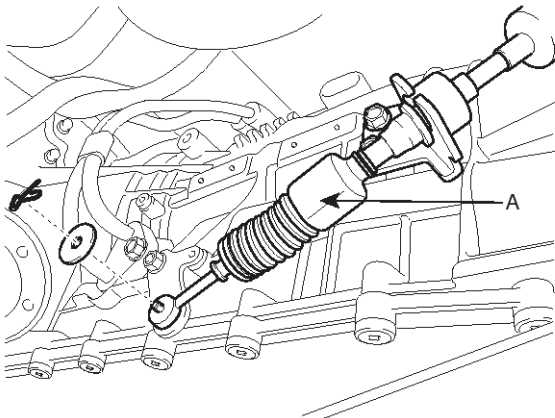

SHMAT8021L

2. Install the shift lever assembly (B) by removing the four bolts(A).

Tightening torque :

9~14 Nm (5.0~6.5 Kgf.m, 36.1~47 lb-ft)

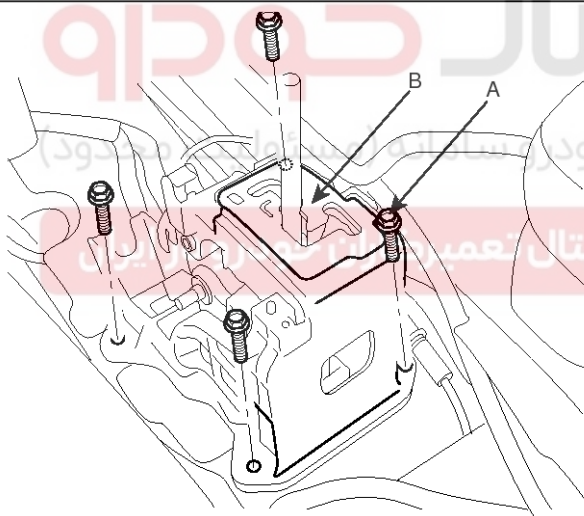

SHMAT8108D

3. Connect the interlock switch connector (A).

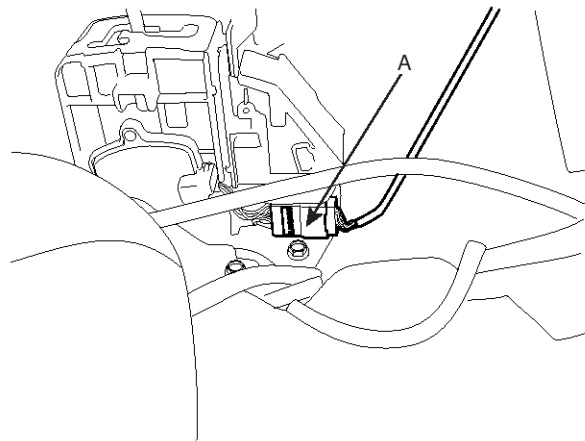

SHMAT8106D

4. After Install the control cable nut (A), Install the shift cable in the 'F' direction by pulling the clip (B) on the floor.

Tightening torque :

9~13 Nm (1.0~1.4 Kgf.m, 7.2~10.1 lb-ft)

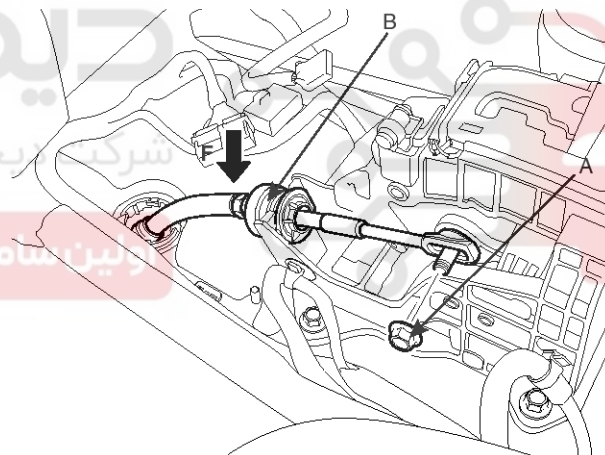

SHMAT8116L

ATA-36

Automatic Transaxle System

5. Install the center console(A).(refer to Console in DS group)

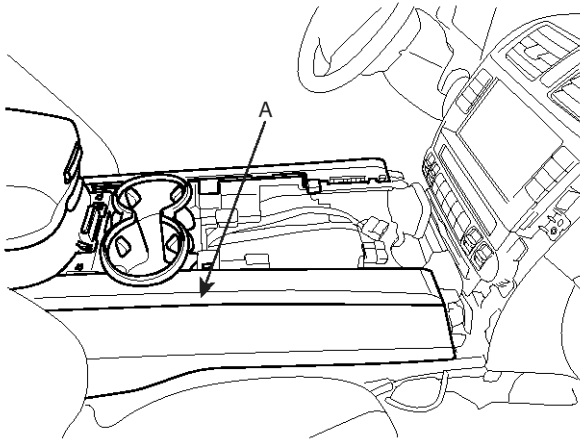

SHMAT8104D

6. Install the tray(A).

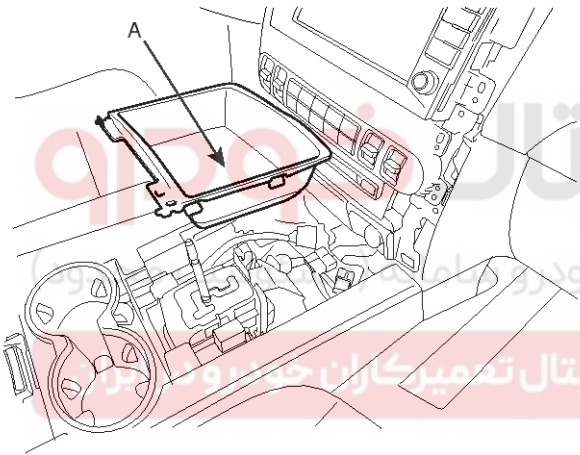

SHMAT8103D

7. Remove the center console cover(A).

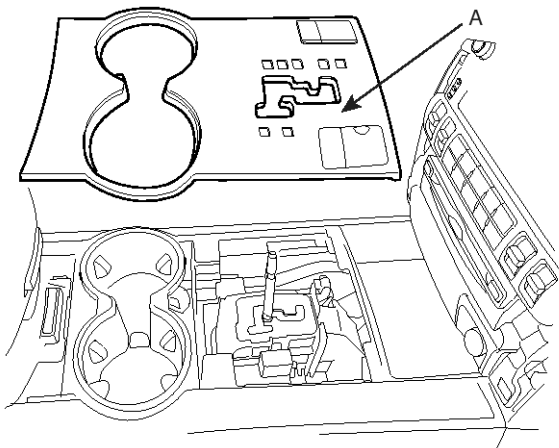

SHMAT8102D

8. Insert the shift lever knob (A) with the specified force.

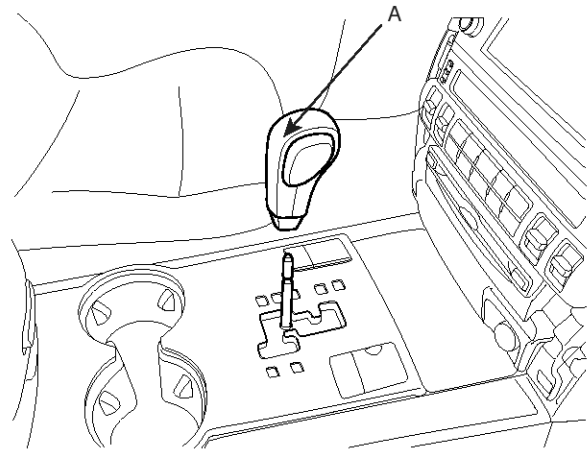

SHMAT8117L

